



1<sup>a</sup> EDIZIONE

# **DINO 2400**

## **spider (tipo 135 BS)**

CATALOGO PARTI DI RICAMBIO CARROZZERIA  
CATALOGUE DE PIÈCES DÉTACHÉES CARROSSERIE  
ERSATZTEILKATALOG KAROSSERIE  
BODYWORK SPARE PARTS CATALOG  
CATÁLOGO DE PIEZAS DE REPUESTO - CARROGERÍA

---

**FIAT - DIREZIONE RICAMBI**

	INDICE DEI SOTTOGRUPPI	INDEX DES SOUSGROUPES	UNTERGRUPPEN- VERZEICHNIS	SUBGROUP INDEX	ÍNDICE DE SUBGRUPOS
<u>L</u>	<u>ESTERNO CARROZZERIA</u>	<u>Extérieur de la car- rosserie</u>	<u>Äussere Karosserie- teile</u>	<u>Body Exterior</u>	<u>Exterior de carroce- ria</u>
<u>L1</u>	<u>SCocca</u>	<u>Coque</u>	<u>Karosseriekasten</u>	<u>Body Shell</u>	<u>Caja</u>
L1.01	Coperchio vano motore	Capot	Motorraumdeckel	Engine Compartment Lid	Tapa del motor
L1.02	Plancia portastrumenti e parti annesse	Planche de bord et an- nexes	Instrumentenbrett u. Zubehör	Instrument Panel and Relevant Parts	Tablero de instrumen- tos y anexos
L1.03	Pavimento	Plancher	Fussboden	Floor	Piso
L1.04	Scocca, elementi in- terni	Coque, éléments intérieurs	Wagenkasten-Innen- teile	Body Shell Inner Elements	Caja, elementos interiores
L1.05	Scocca, elementi e- sterni	Coque, éléments extérieurs	Wagenkasten-Aus- senteile	Body Shell Outer Elements	Caja, elementos exteriores
L1.06	Capote	Capote	Verdeck	Folding Top	Capota
L1.09	Porte	Portes	Türen	Doors	Puertas
L1.18	Parabrezza	Pare-brise	Windschutzscheibe	Windshield	Parabrisas
L1.23	Coperchio vano бага- gli	Couvercle de coffre	Kofferraumdeckel	Luggage Compartment Lid	Tapa del baúl
L1.25	Modanature e guarni- zioni esterne	Moulures et garnitures extérieures	Äussere Verzierungen	Outer Trim Mouldings	Molduras exteriores
<u>L3</u>	<u>PROTEZIONE</u>	<u>Protection</u>	<u>Schutz- und Abdeck- bleche</u>	<u>Protective and Trim Sheeting</u>	<u>Defensas</u>
L3.01	Griglia radiatore	Grille de radiateur	Kühlergitter	Radiator Grille	Calandra de radiador
L3.02	Ripari	Protections	Abdeckungen und Dichtungen	Protection Items	Elementos de protec- ción
L3.06	Paraurti anteriore	Pare-chocs AV	Vorderer Stossfänger	Front Bumper	Parachoques anterior
L3.07	Paraurti posteriore	Pare-chocs AR	Hinterer Stossfänger	Rear Bumper	Parachoques posterior

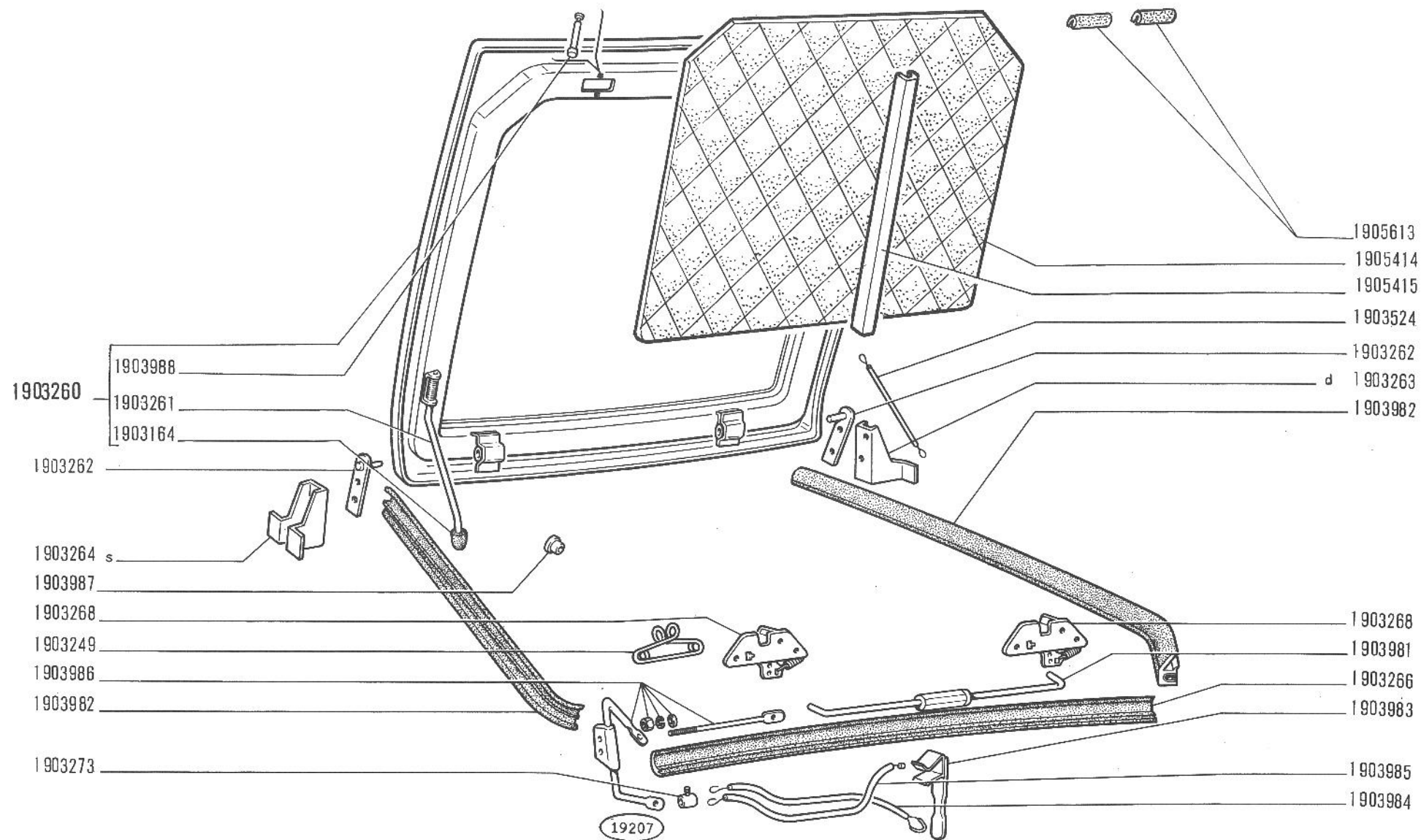

**FIAT DINO 2400**  
(tipo 135 BS)

- Capot
- Motorraumdeckel

## COPERCHIO VANO MOTORE

- Engine Compartment Lid
- Tapa del motor

1

**L1.01**

IV-1970

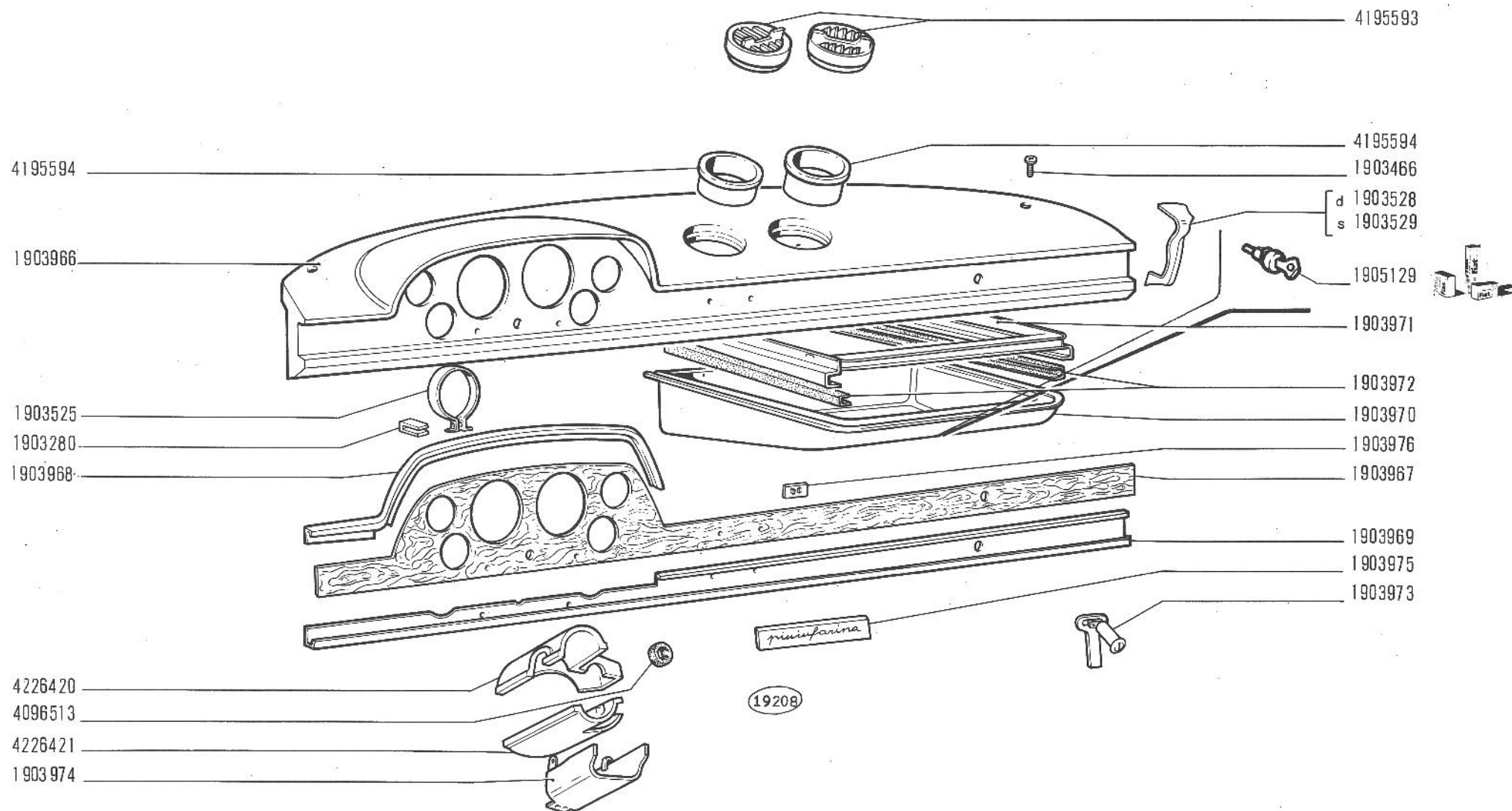

**FIAT DINO 2400**  
(tipo 135 BS)

## PLANCIA PORTAISTRUMENTI E PARTI ANNESSE

- *Planche de bord et annexes*
- *Instrumentenbrett und Zubehör*

- *Instrument Panel and Relevant Parts*
- *Tablero de instrumentos y anexos*

**L1.02**

IV-1970

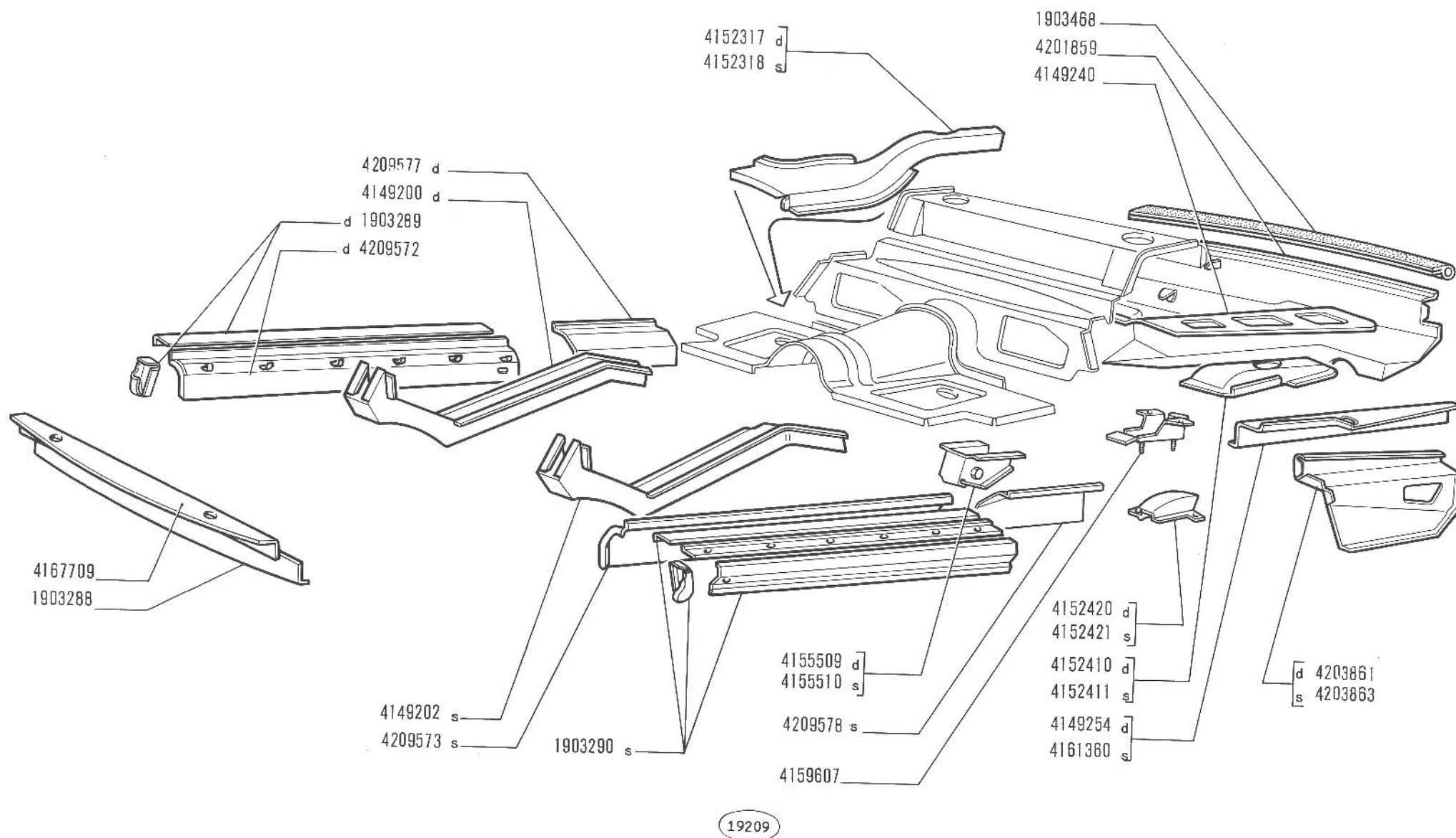

**FIAT DINO 2400**  
(tipo 135 BS)

- Plancher
- Fussboden

## PAVIMENTO

- Floor
- Piso

**L1.03**

IV-1970

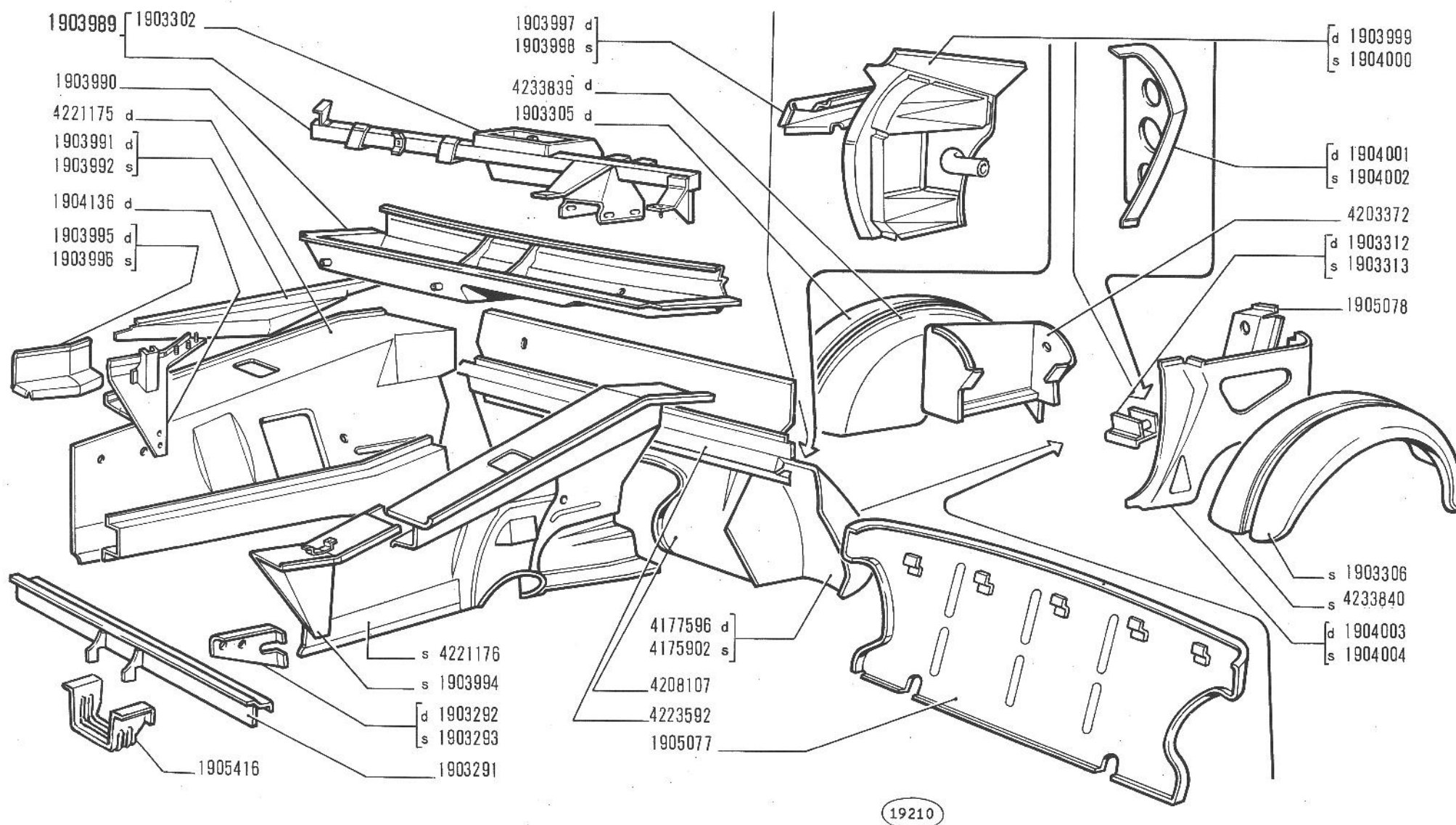

**FIAT DINO 2400**  
(tipo 135 BS)

● Coque, éléments intérieurs  
● Wagenkasten-Innenteile

## SCocca, ELEMENTI INTERNI

● Body Shell Inner Elements  
● Caja, elementos interiores

**L1.04**

VI-1970

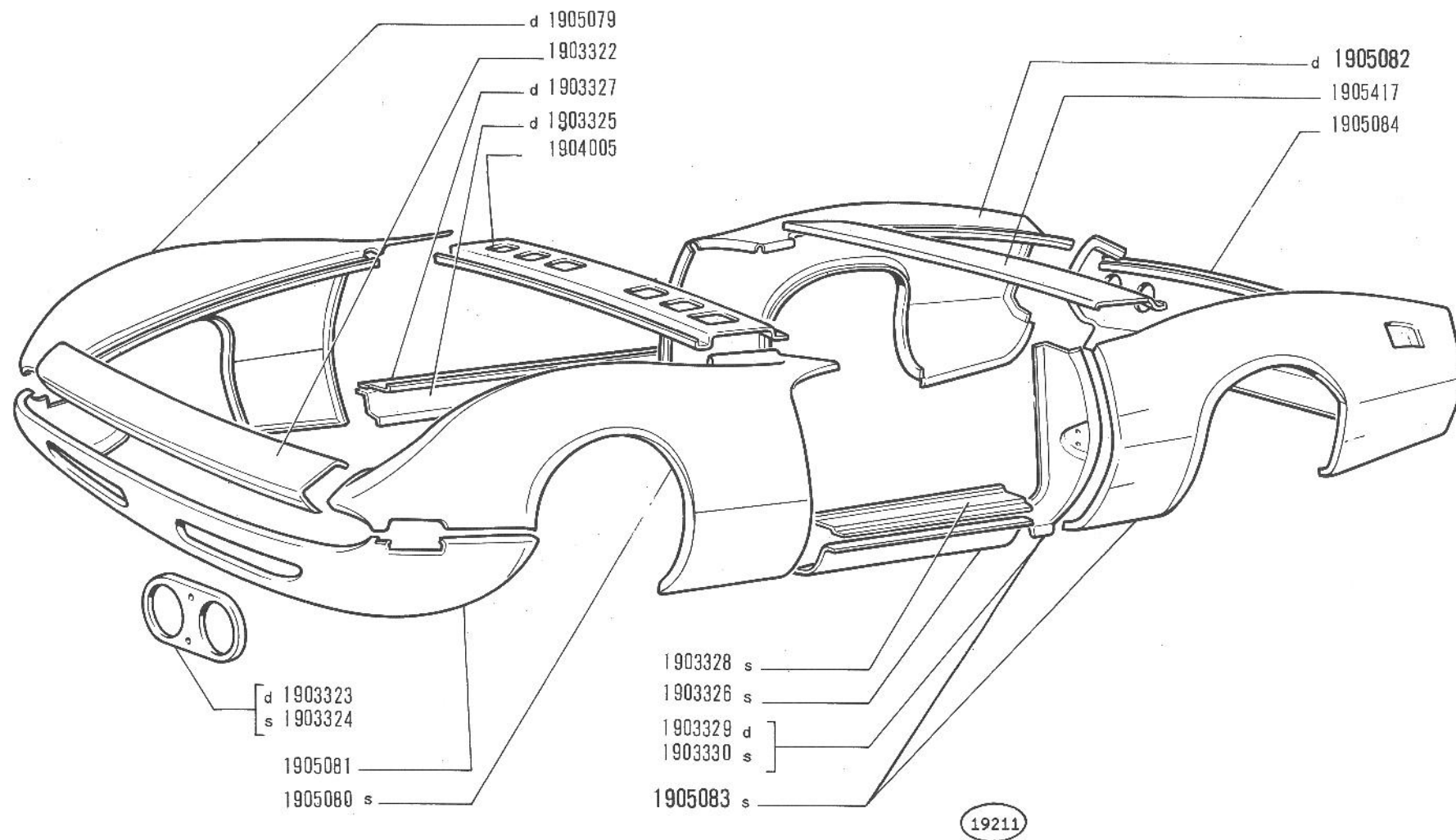

**FIAT DINO 2400**  
(tipo 135 BS)

## SCocca, ELEMENTI ESTERNI

- Coque, éléments extérieurs
- Wagenkasten-Aussenteile

- Body Shell Outer Elements
- Caja, elementos exteriores

**L1.05**

IV-1970

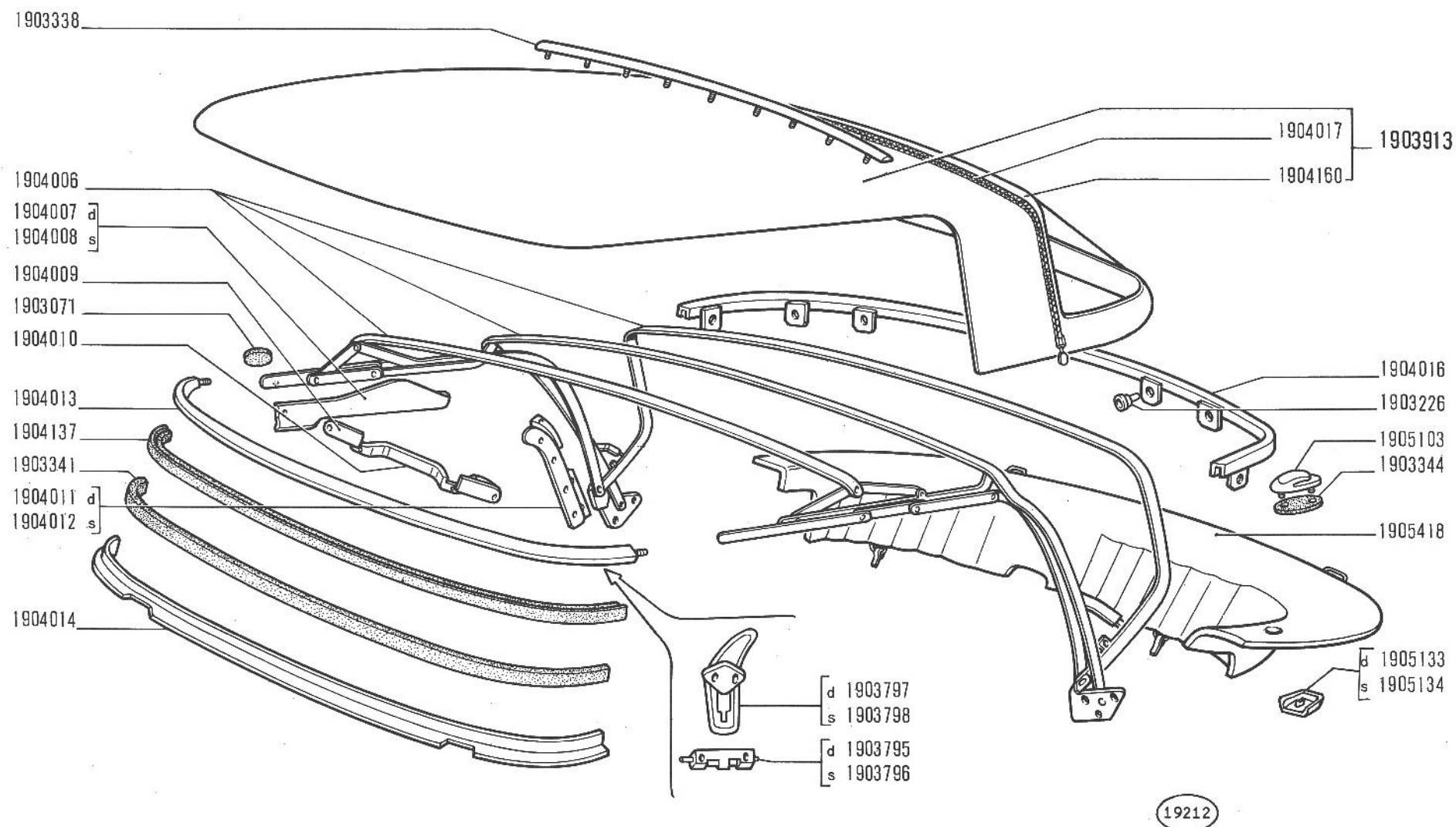

**FIAT DINO 2400**  
(tipo 135 BS)

- Capote
- Verdeck

## CAPOTE

- Folding Top
- Capota

2

**L1.06**

IV-1970



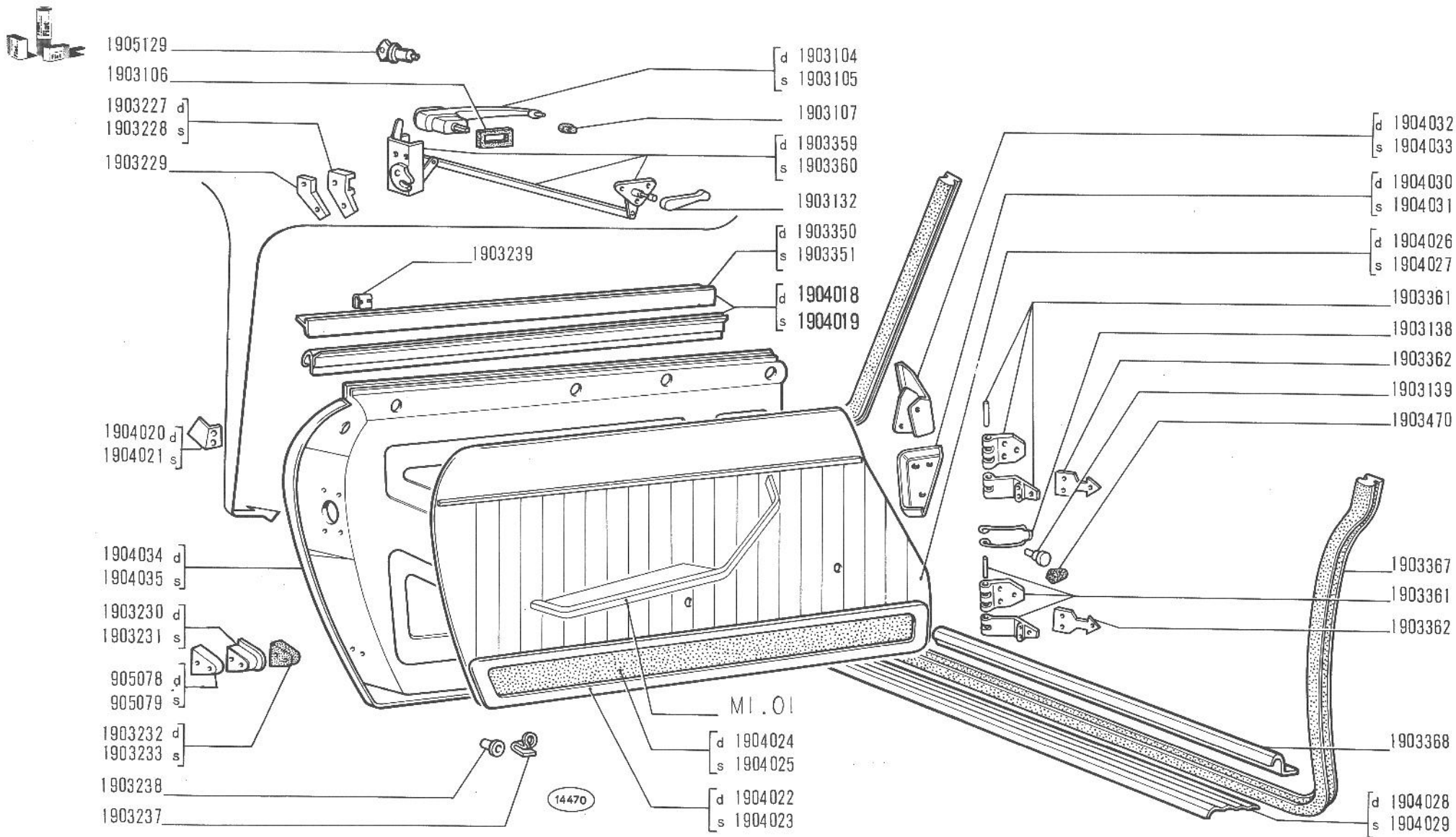

**FIAT DINO 2400**  
(tipo 135 BS)

● Portes  
● Türen

## PORTE

● Doors  
● Puertas

2

**L1.09**

1/2

VI-1970

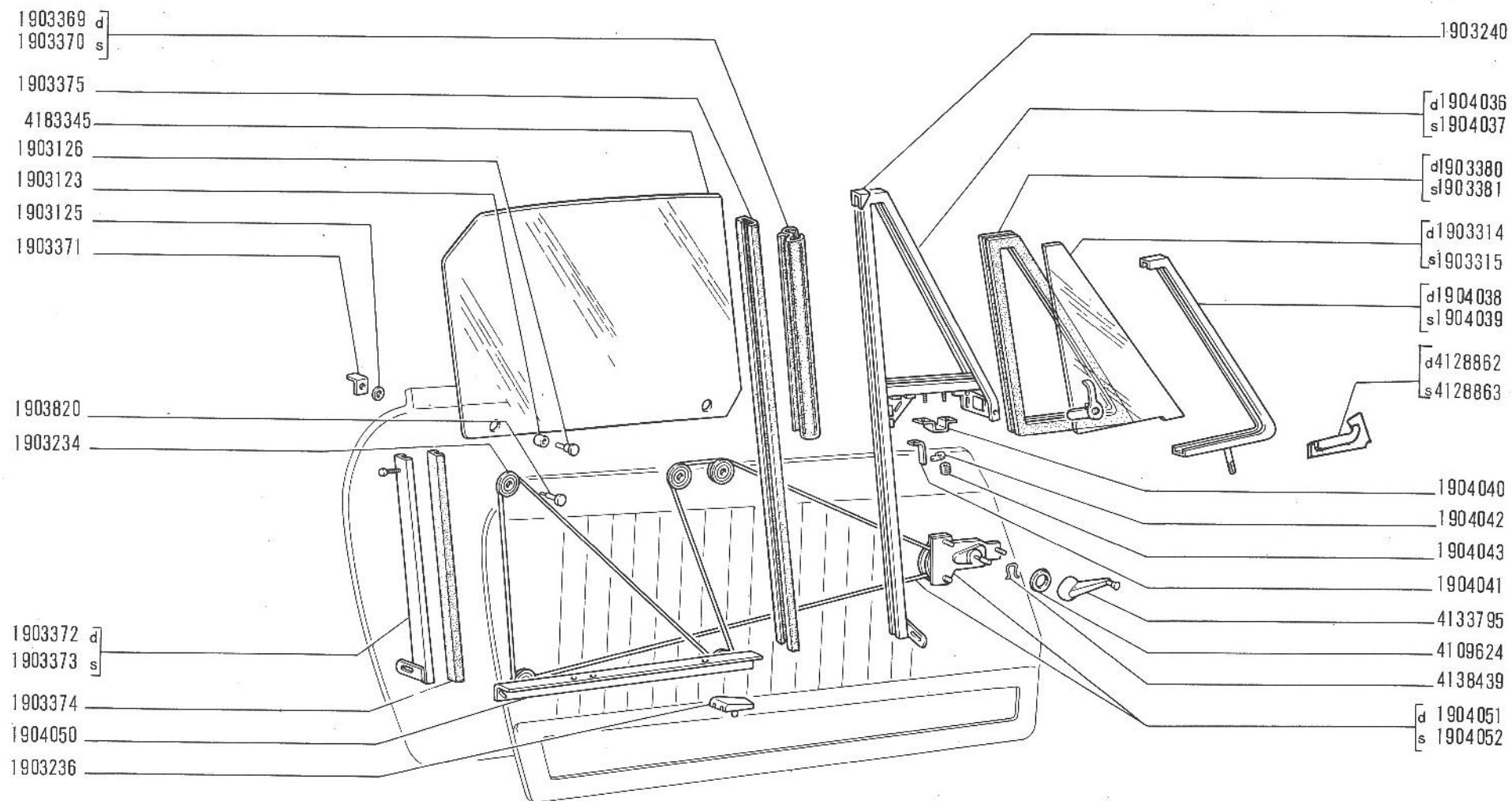

14471

**FIAT DINO 2400**  
(tipo 135 BS)

● Portes  
● Türen

## PORTE

● Doors  
● Puertas

2

**L1.09**

2/2

IV-1970

modif.	n. ordinaz.	quant.	Denominazione	Désignation	Benennung	Description	Denominaciones
	4128862	1	Gocciolatoio d	Gouttière	Dachrinne	Trough	Vierteaguas
	4128863	1	Gocciolatoio s	Gouttière	Dachrinne	Trough	Vierteaguas
	4133795	2	Maniglia alzacristallo	Poignée	Kurbel	Handle	Manivela
	4138439	2	Molletta	Agrafe	Klemmstück	Clip	Sujetador
	4183345	2	Cristallo scendente	Glace	Glasscheibe	Glass	Cristal
	1905129	S	Blocchetti chiusura	Barillets	Schlosszylinder	Lock cylinders	Cilindros
3/3	L1.09		Fiat Dino 2400 Spider (BS) carr.				

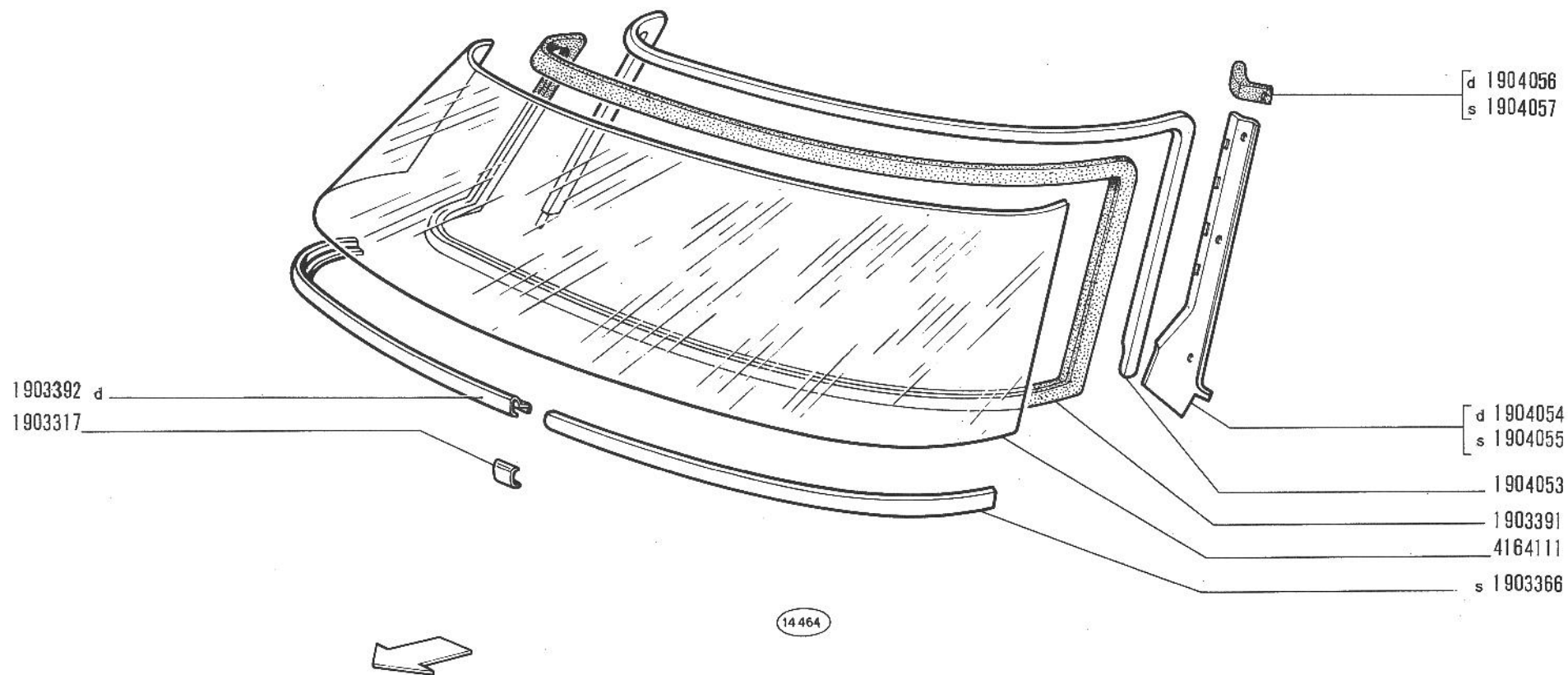

**FIAT DINO 2400**  
(tipo 135 BS)

- Pare-brise
- Windschutzscheibe

## PARABREZZA

- Windshield
- Parabrisas

2

**L1.18**

IV-1970

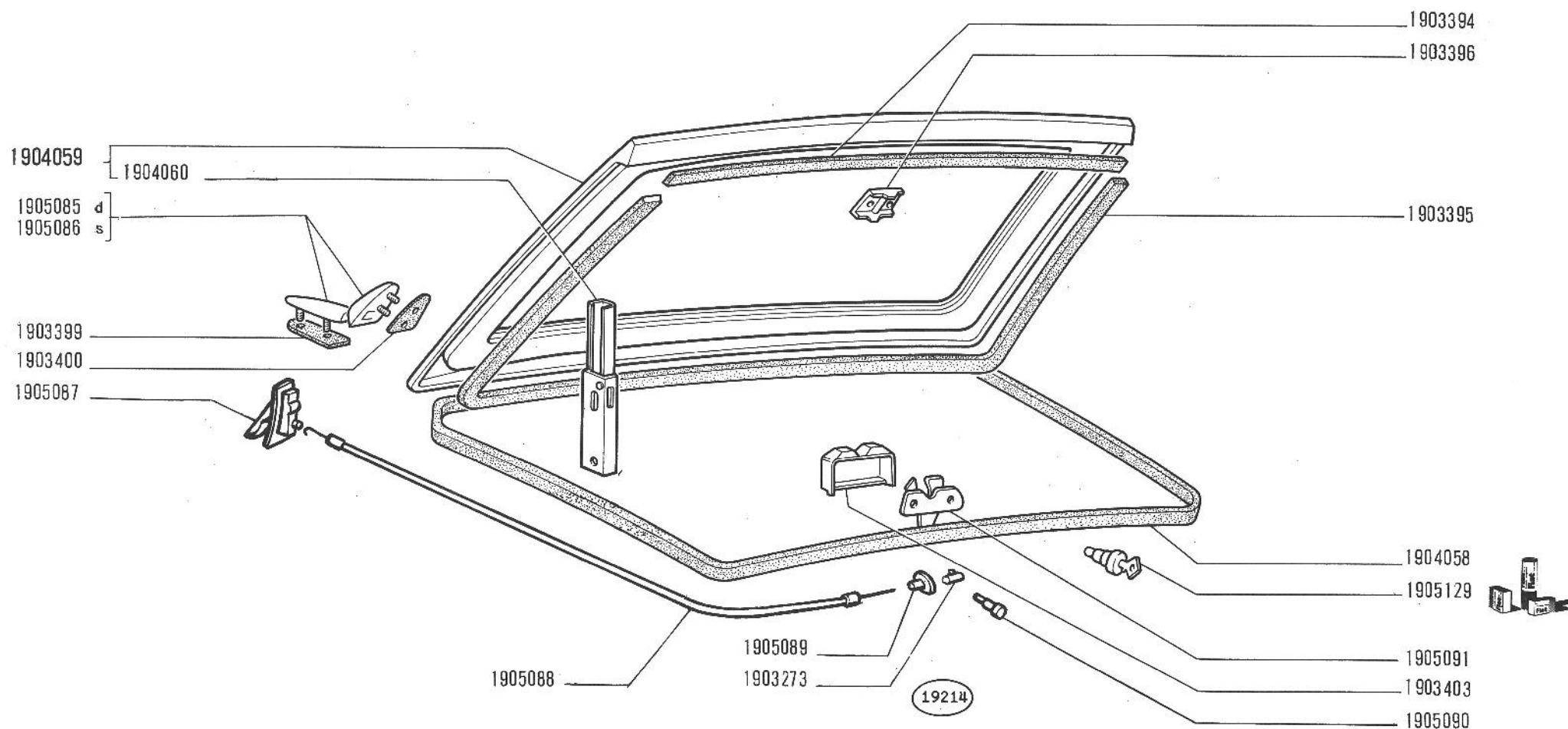

**FIAT DINO 2400**  
(tipo 135 BS)

- Couvercle de coffre
- Kofferraumdeckel

## COPERCHIO VANO BAGAGLI

- Luggage Compartment Lid
- Tapa del baúl

**L1.23**

IV-1970

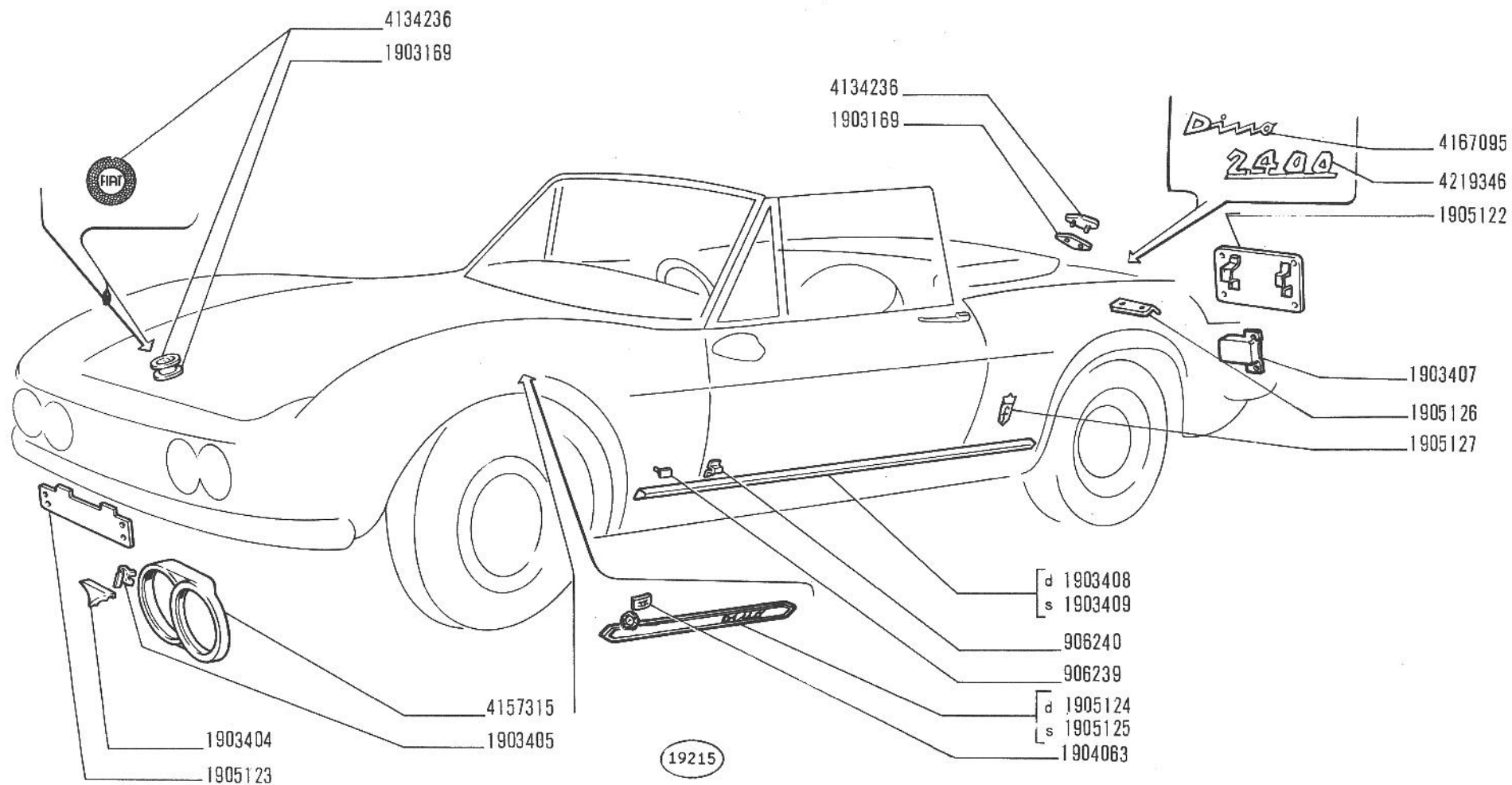

**FIAT DINO 2400**  
(tipo 135 BS)

### MODANATURE E GUARNIZIONI ESTERNE

- Moulures et garnitures extérieures
- Äussere Verzierungen

- Outer Trim Mouldings
- Molduras exteriores

**L1.25**

IV-1970

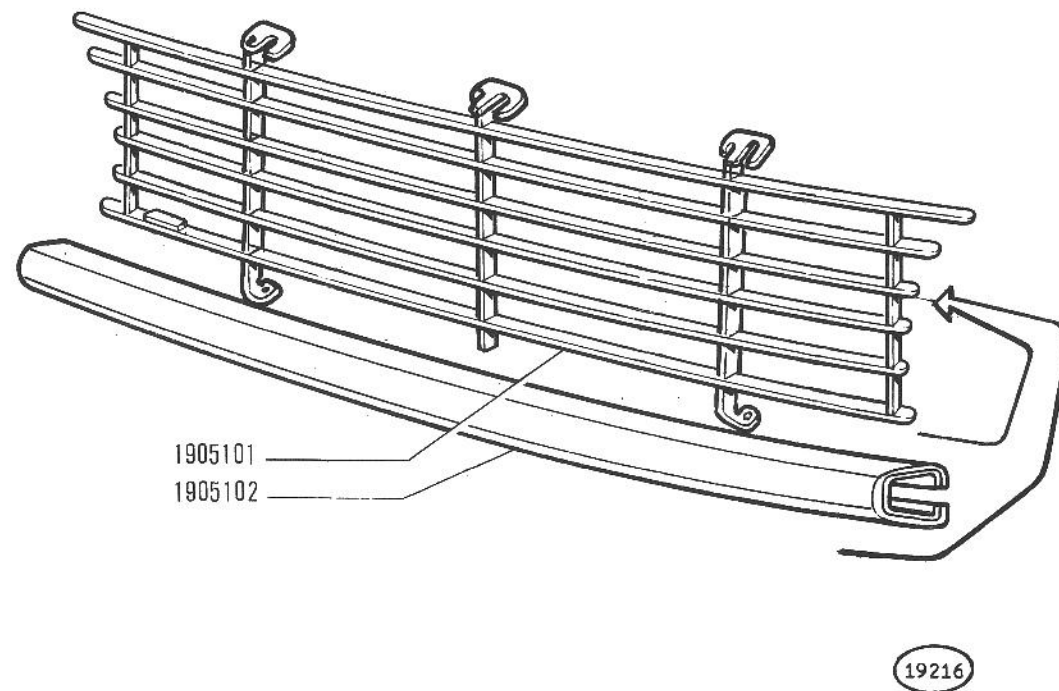

**FIAT DINO 2400**  
(tipo 135 BS)

- Calandre de radiateur
- Kühlerhaube

## CUFFIA RADIATORE

- Radiator Panel
- Calandra de radiador

**L3.01**

IV-1970

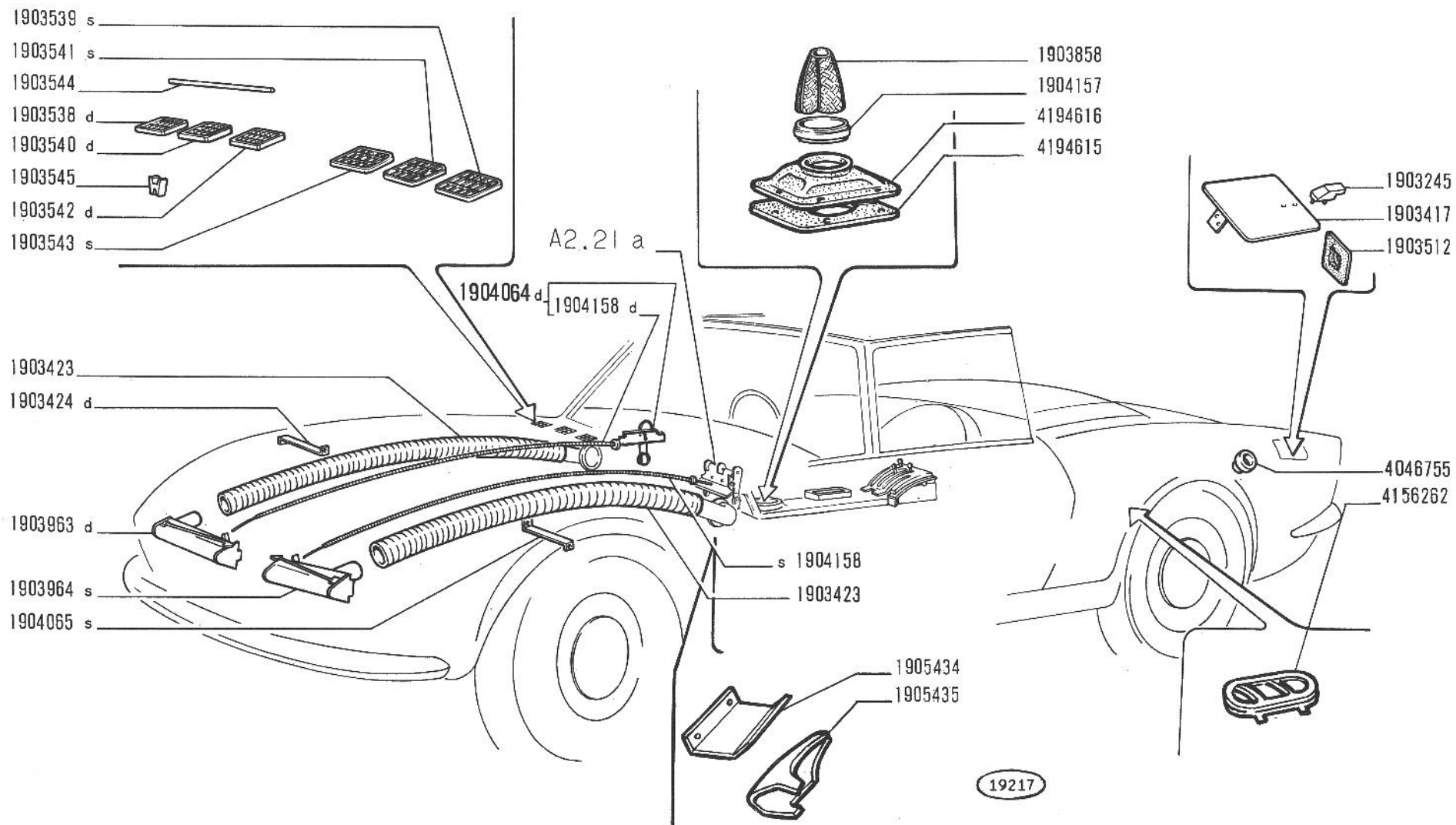

**FIAT DINO 2400**  
(tipo 135 BS)

- *Protections*
- *Abdeckungen und Dichtungen*

## RIPARI

- *Protection Items*
- *Elementos de protección*

**L3.02**

IV-1970



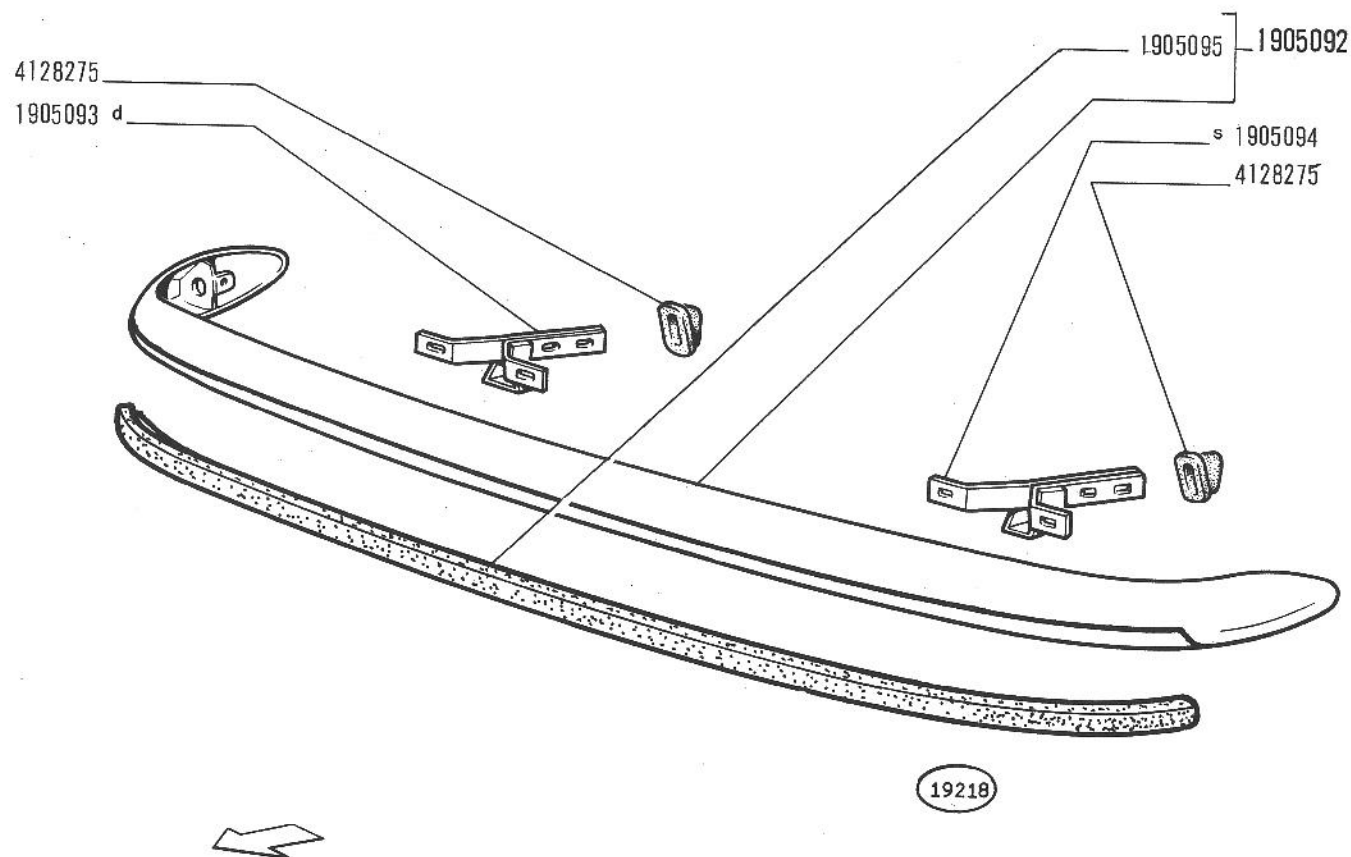

**FIAT DINO 2400**  
(tipo 135 BS)

- Pare-chocs AV
- Vorderer Stossfänger

## PARAURTI ANTERIORE

- Front Bumper
- Parachoques anterior

**L3.06**

IV-1970

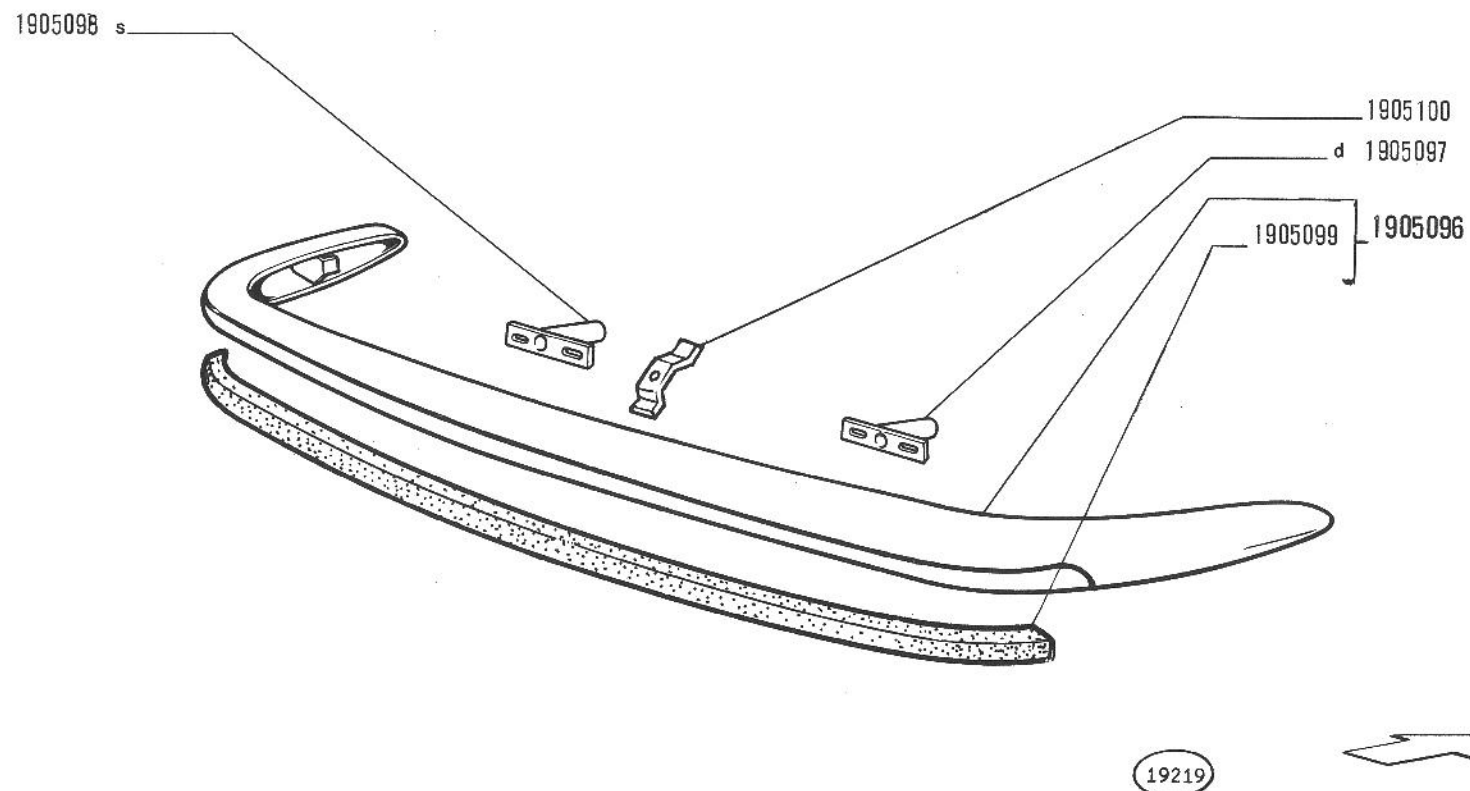

**FIAT DINO 2400**  
(tipo 135 BS)

- Pare-chocs AR
- Hinterer Stossfänger

## PARAURTI POSTERIORE

- Rear Bumper
- Parachoques posterior

**L3.07**

IV-1970

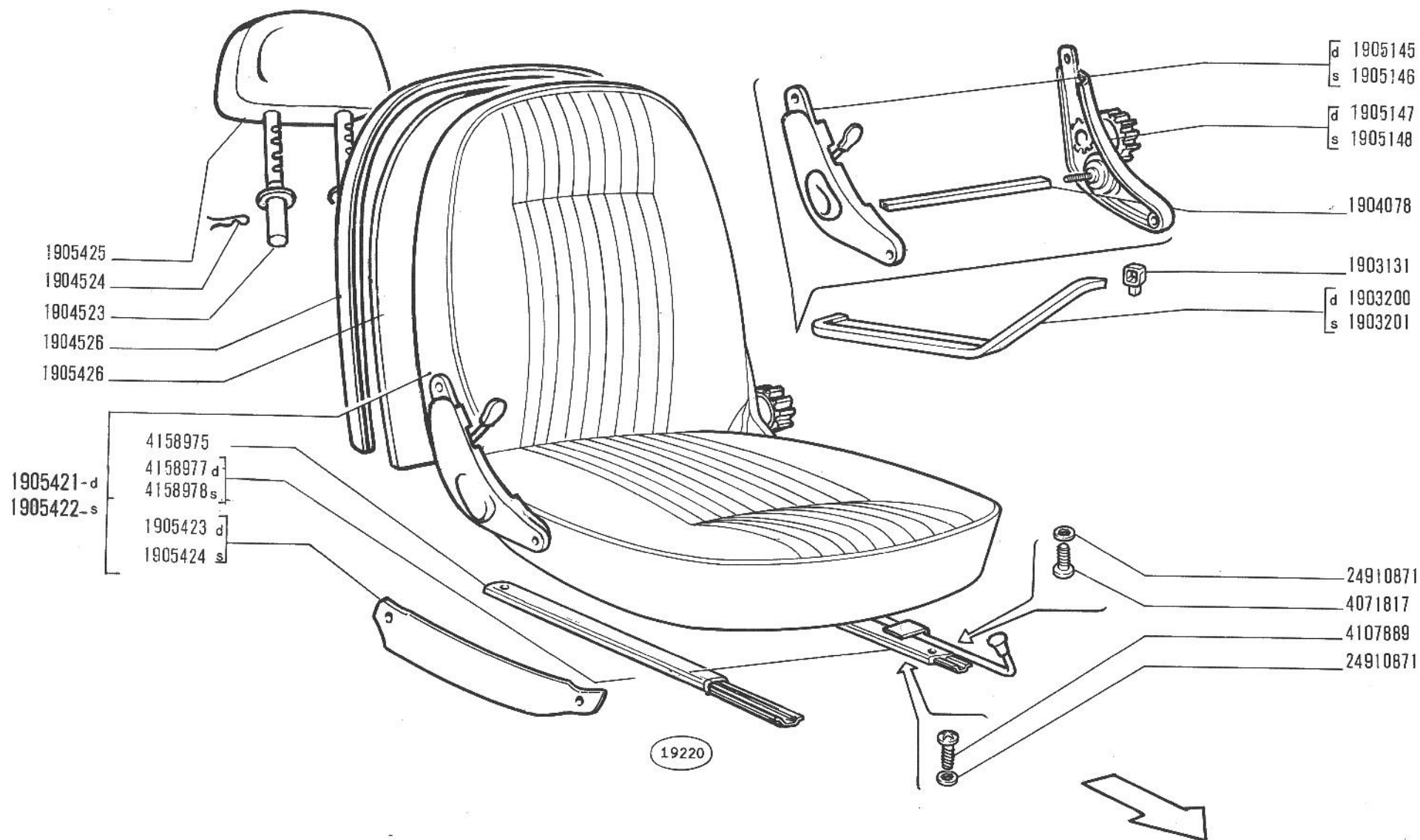

**FIAT DINO 2400**  
(tipo 135 BS)

● Sièges avant  
● Vordersitze

## SEDILI ANTERIORI

● Front Seats  
● Butacas anteriores

**M1.01**

IV-1970

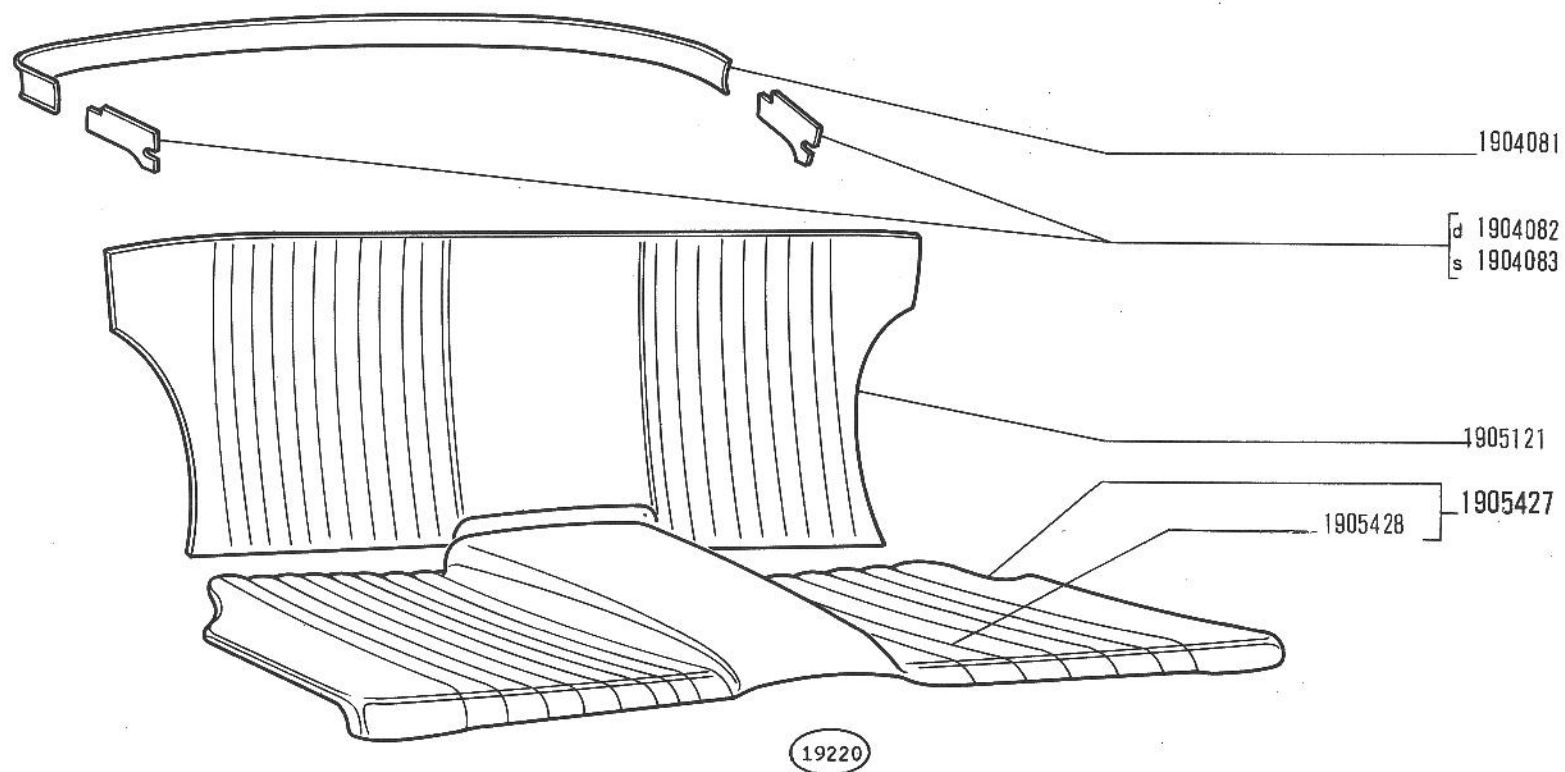

**FIAT DINO 2400**  
(tipo 135 BS)

- *Siège arrière*
- *Hintersitz*

## **SEDILE POSTERIORE**

- *Rear Seat*
- *Butaca posterior*

1

**M1.02**

*IV-1970*

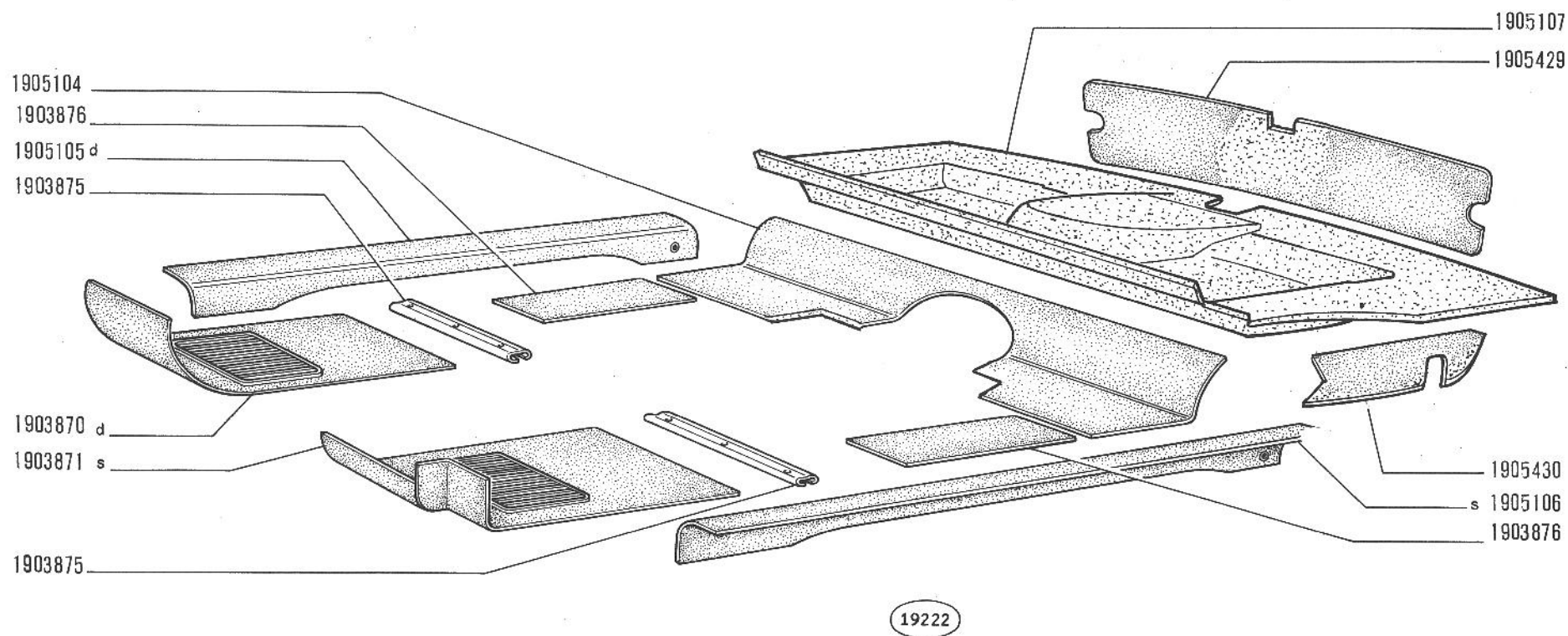

**FIAT DINO 2400**  
(tipo 135 BS)

- Tapis
- Bodenbeläge

## TAPPETI

- Mats
- Alfombras

**M1.06**

IV-1970

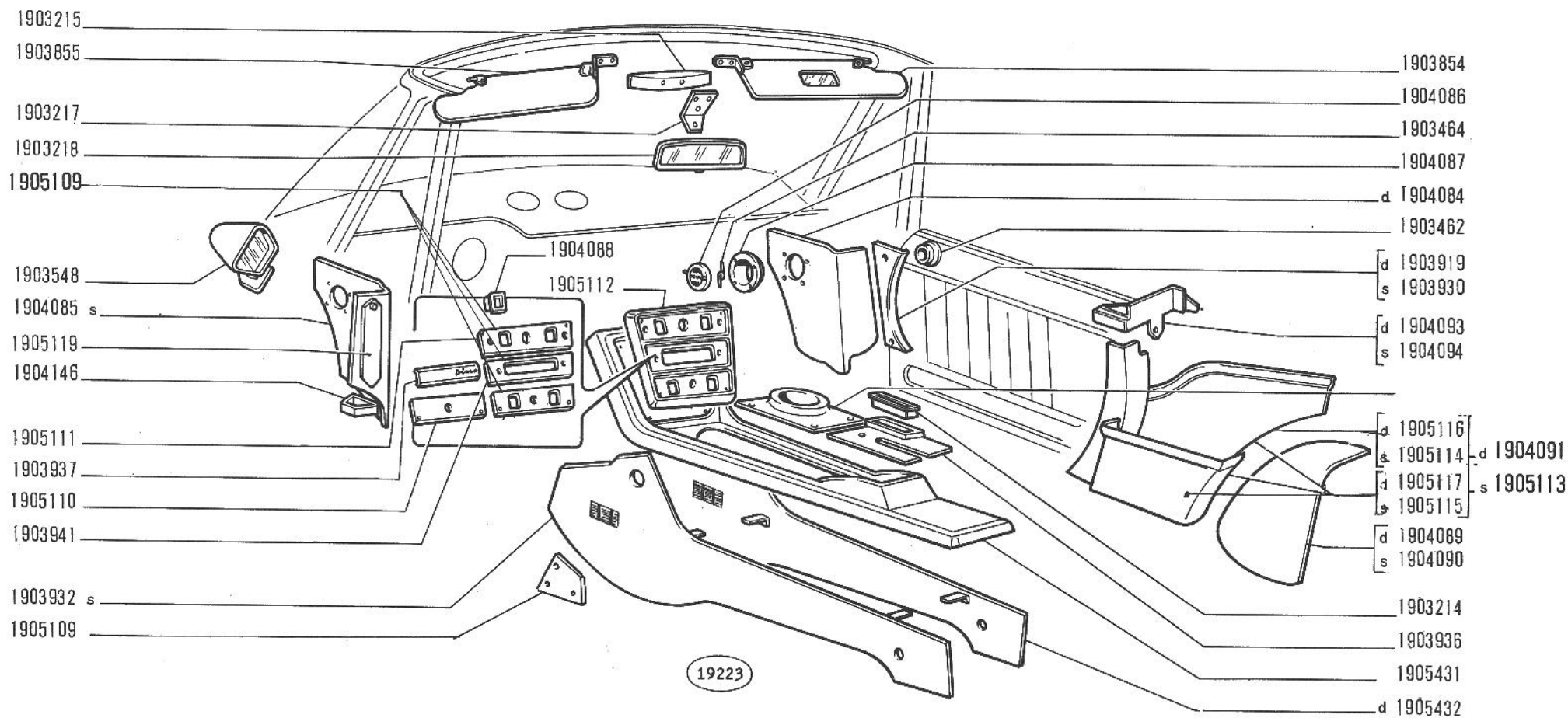

**FIAT DINO 2400**  
(tipo 135 BS)

## ACCESSORI E RIVESTIMENTI INTERNI

- Accessoires et garnissages intérieurs
- Inneres Zubehör und Verkleidungen

- Interior Trim and Accessories
- Accesorios y tapizado interiores

**M1.07**

IV-1970