



1^a EDIZIONE

DINO 2400

coupé (tipo 135 BC)

CATALOGO PARTI DI RICAMBIO CARROZZERIA
CATALOGUE DE PIÈCES DÉTACHÉES CARROSSERIE
ERSATZTEILKATALOG KAROSSERIE
BODYWORK SPARE PARTS CATALOG
CATÁLOGO DE PIEZAS DE REPUESTO - CARROCERÍA

FIAT - D I R E Z I O N E R I C A M B I

	INDICE DEI SOTTOGRUPPI	INDEX DES SOUSGROUPES	UNTERGRUPPEN- VERZEICHNIS	SUBGROUP INDEX	ÍNDICE DE SUBGRUPOS
<u>L</u>	<u>ESTERNO CARROZZERIA</u>	<u>Extérieur de la car- rosserie</u>	<u>Äussere Karosserie- teile</u>	<u>Body Exterior</u>	<u>Exterior de carroce- ria</u>
<u>L1</u>	<u>SCOCCA</u>	<u>Coque</u>	<u>Karosseriekasten</u>	<u>Body Shell</u>	<u>Caja</u>
L1.01	Coperchio vano motore	Capot	Motorraumdeckel	Engine Compartment Lid	Tapa del motor
L1.02	Plancia portastrumenti e parti annesse	Planche de bord et an- nexes	Instrumentenbrett u. Zubehör	Instrument Panel and Relevant Parts	Tablero de instrumen- tos y anexos
L1.03	Pavimento	Plancher	Fussboden	Floor	Piso
L1.04	Scocca, elementi in- terni	Coque, éléments intérieurs	Wagenkasten-Innen- teile	Body Shell Inner Elements	Caja, elementos interiores
L1.05	Scocca, elementi e- sterni	Coque, éléments extérieurs	Wagenkasten-Aus- senteile	Body Shell Outer Elements	Caja, elementos exteriores
L1.09	Porte	Portes	Türen	Doors	Puertas
L1.18	Parabrezza	Pare-brise	Windschutzscheibe	Windshield	Parabrisas
L1.19	Finestra laterale	Baie de custode	Seitenfenster	Rear Quarter Window	Ventana lateral
L1.20	Finestra posteriore	Lunette AR	Rückwandfenster	Back Window	Ventana trasera
L1.23	Coperchio vano бага- gli	Couvercle de coffre	Kofferraumdeckel	Luggage Compartment Lid	Tapa del baúl
L1.25	Modanature e guarni- zioni esterne	Moulures et garnitures extérieures	Äussere Verzierungen	Outer Trim Mouldings	Molduras exteriores
<u>L3</u>	<u>PROTEZIONE</u>	<u>Protection</u>	<u>Schutz- und Abdeck- bleche</u>	<u>Protective and Trim Sheeting</u>	<u>Defensas</u>
L3.01	Griglia radiatore	Grille de radiateur	Kühlergitter	Radiator Grille	Calandra de radiador
L3.02	Ripari	Protections	Abdeckungen und Dichtungen	Protection Items	Elementos de protec- ción

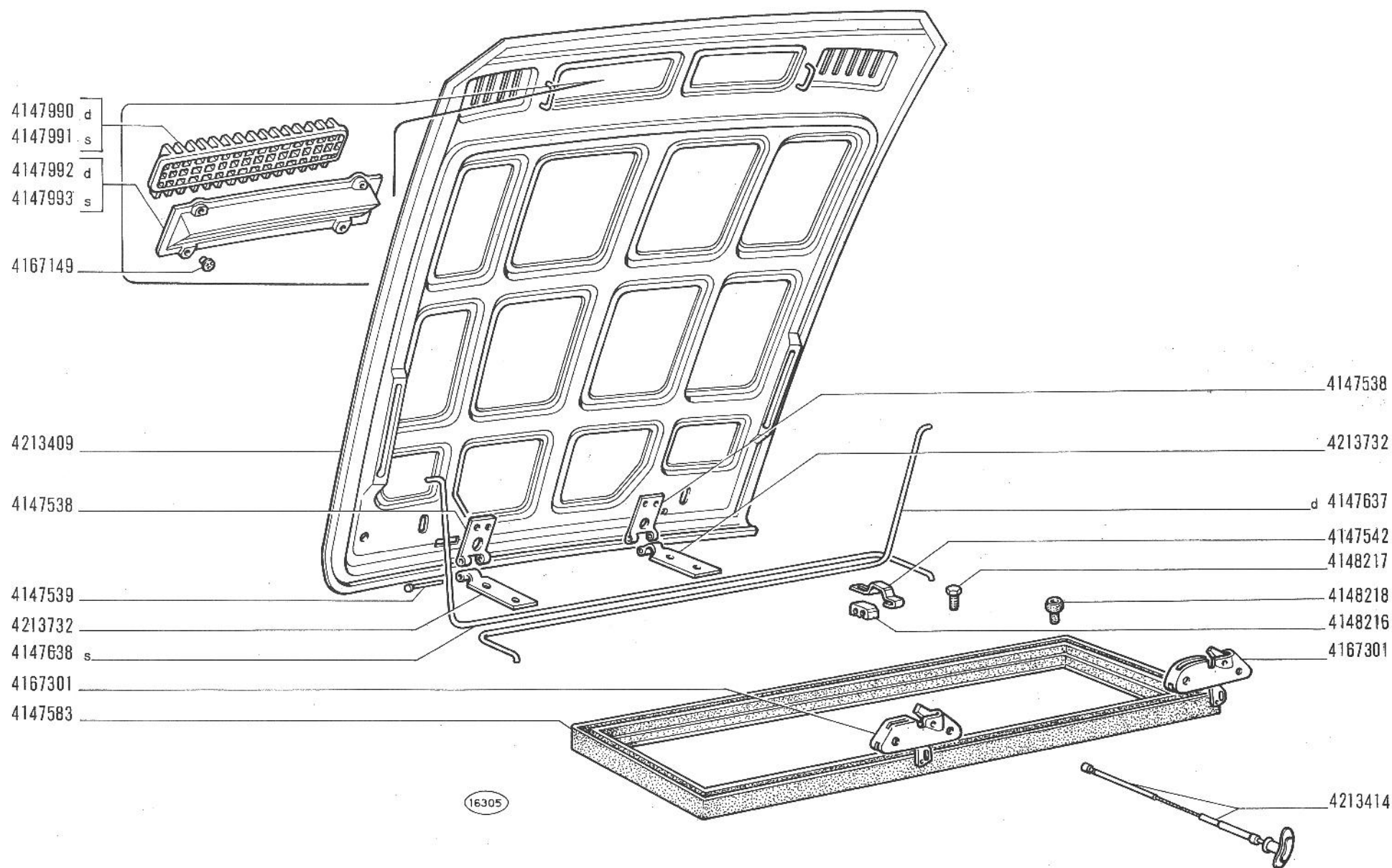

FIAT DINO 2400
(tipo 135 BC)

• Capot
• Motorraumdeckel

COPERCHIO VANO MOTORE

• Engine Compartment Lid
• Tapa del motor

L1.01

X-1969

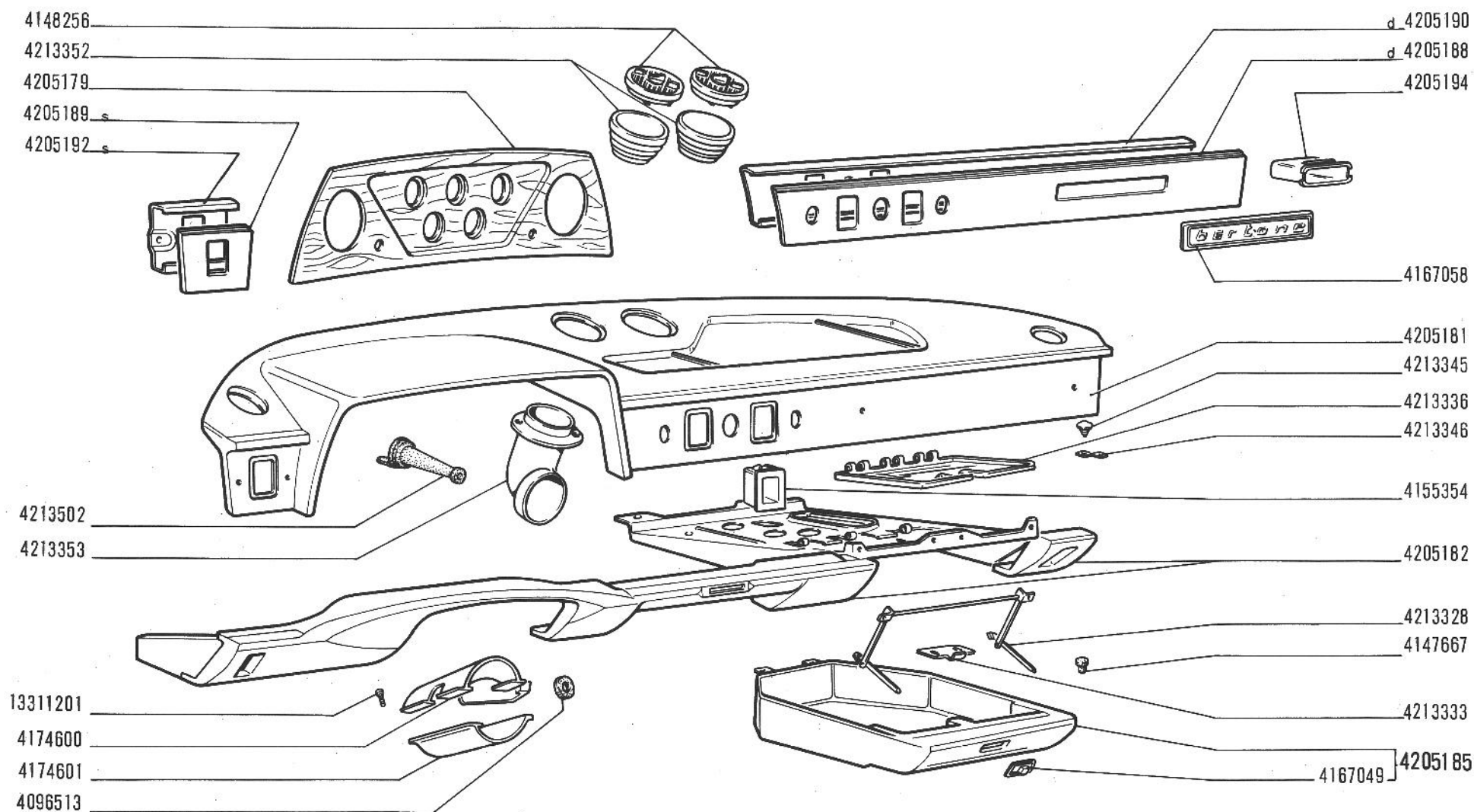

16306

FIAT DINO 2400
(tipo 135 BC)

PLANCIA PORTAISTRUMENTI E PARTI ANNESSE

- Planche de bord et annexes
- Instrumentenbrett und Zubehör

- Instrument Panel and Relevant Parts
- Tablero de instrumentos y anexos

L1.02

X-1969

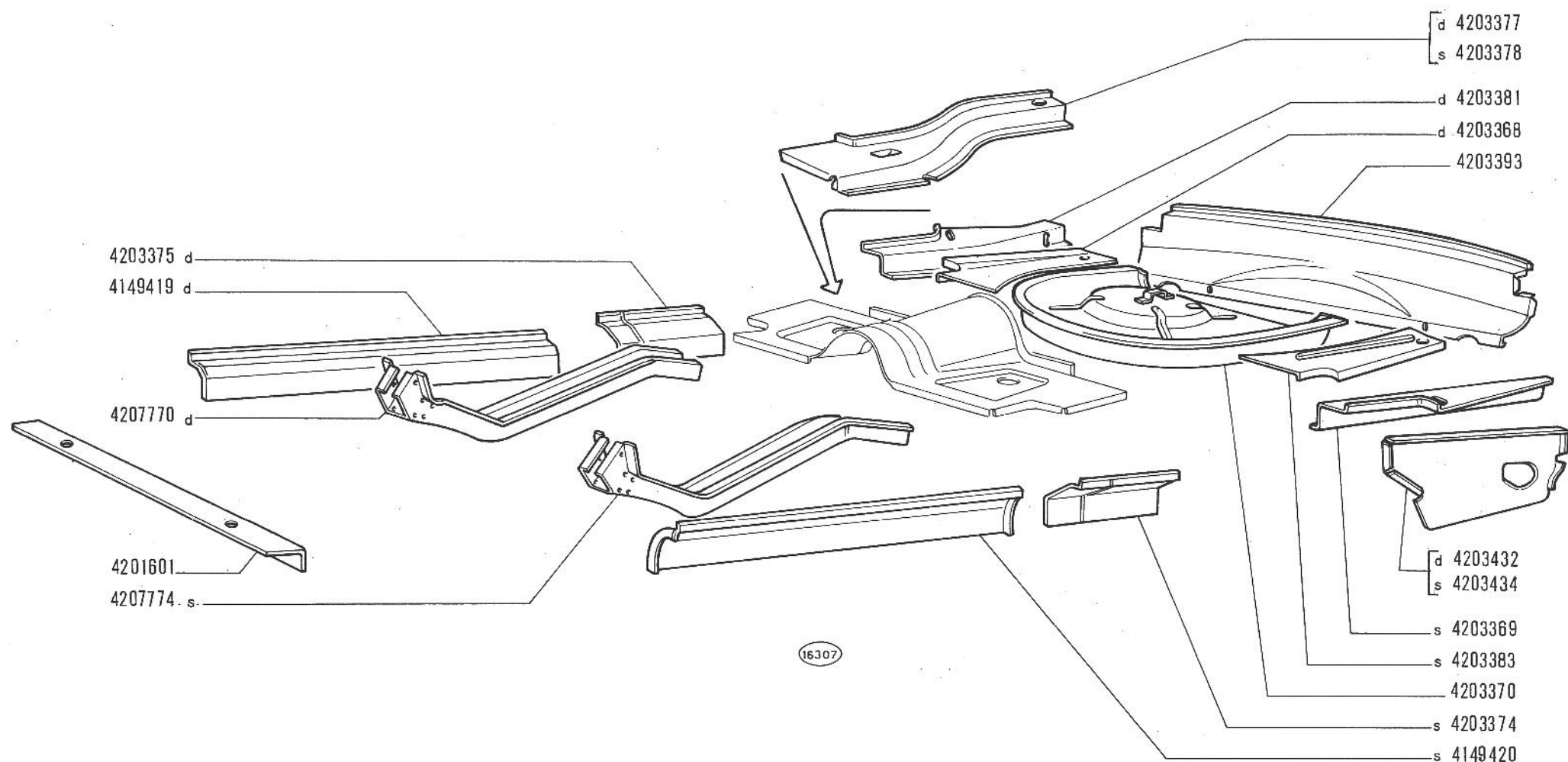

FIAT DINO 2400
(tipo 135 BC)

• Plancher
• Fussboden

PAVIMENTO

• Floor
• Piso

L1.03

X-1969

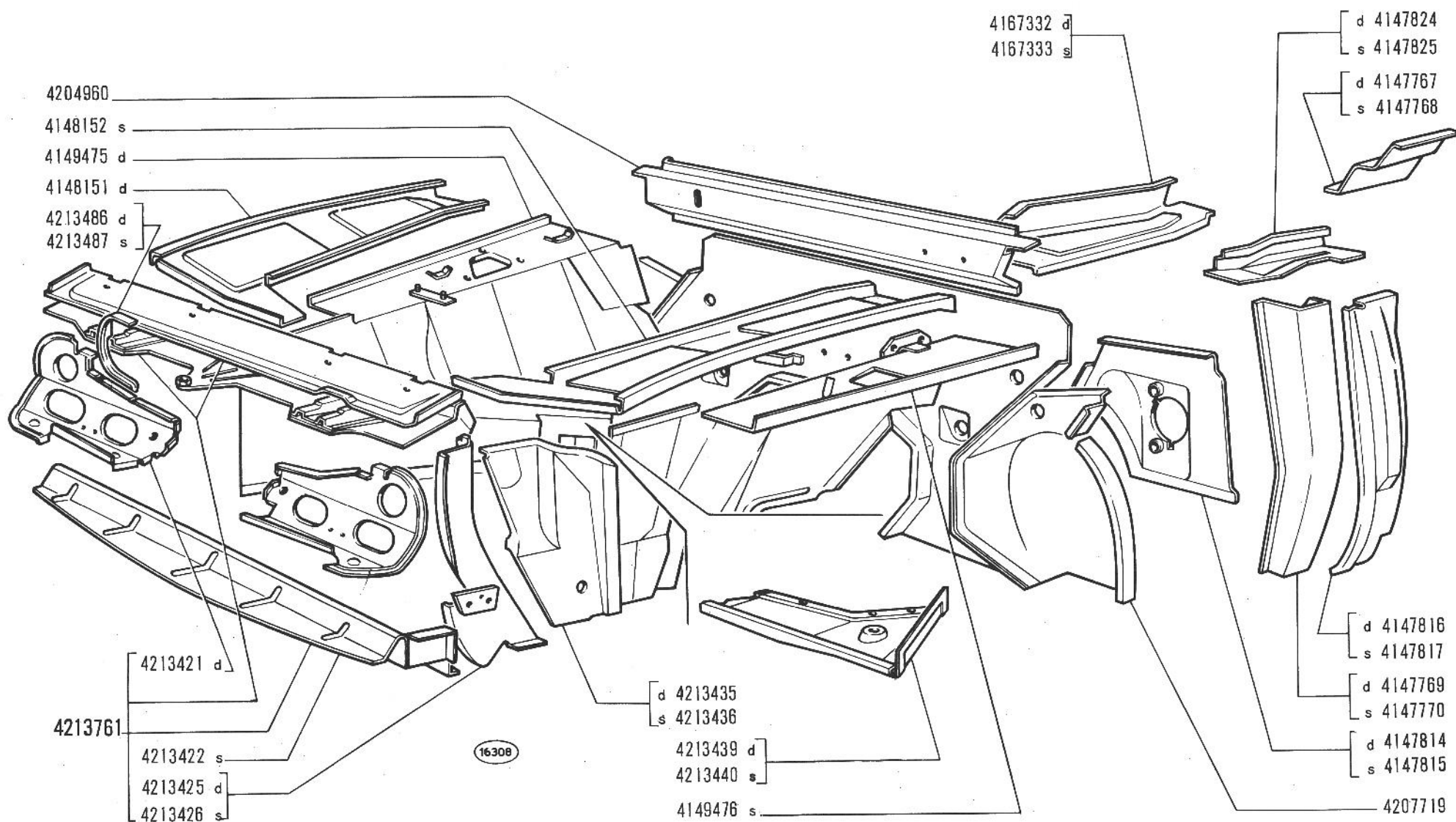

FIAT DINO 2400
(tipo 135 BC)

SCocca, ELEMENTI INTERNI

- Coque, éléments intérieurs
- Wagenkasten-Innenteile

- Body Shell Inner Elements
- Caja, elementos interiores

L1.04

1/3

X-1969

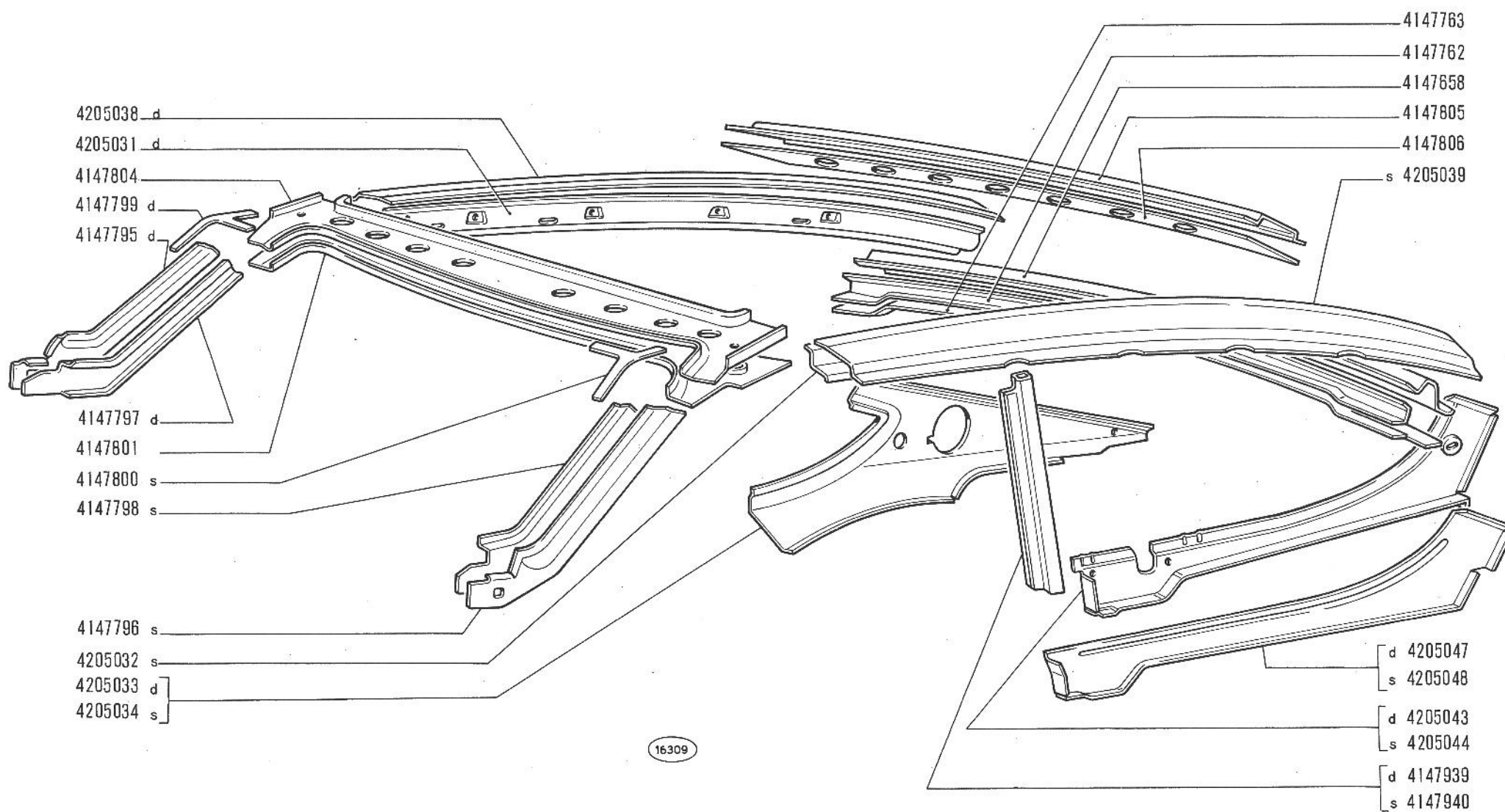

FIAT DINO 2400
(tipo 135 BC)

SCocca, ELEMENTI INTERNI

- Coque, éléments intérieurs
- Wagenkasten-Innenteile

- Body Shell Inner Elements
- Caja, elementos interiores

L1.04

2/3

X-1969

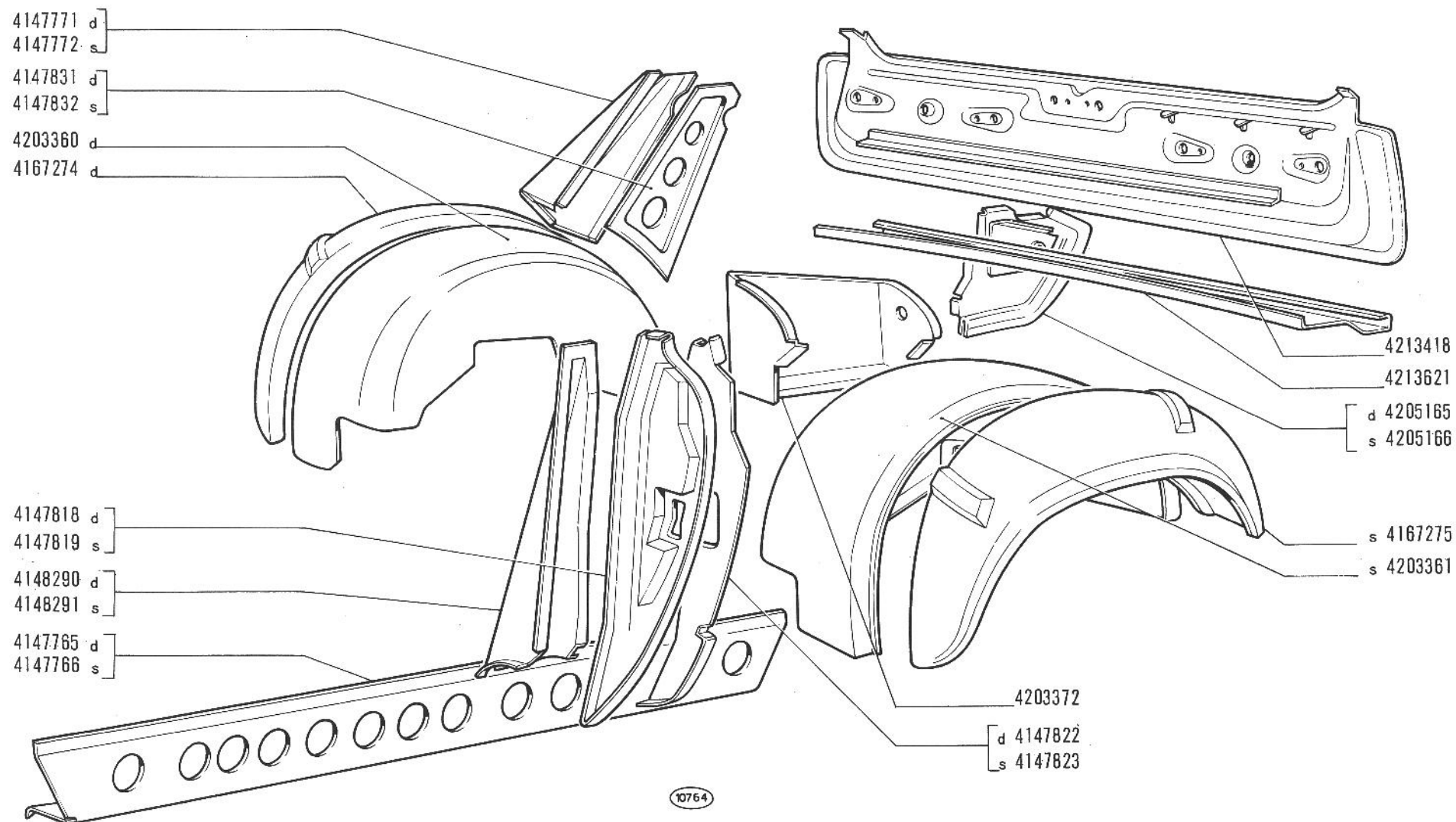

FIAT DINO 2400
(tipo 135 BC)

SCocca, ELEMENTI INTERNI

- Coque, éléments intérieurs
- Wagenkasten-Innenteile

- Body Shell Inner Elements
- Caja, elementos interiores

L1.04

3/3

X-1969

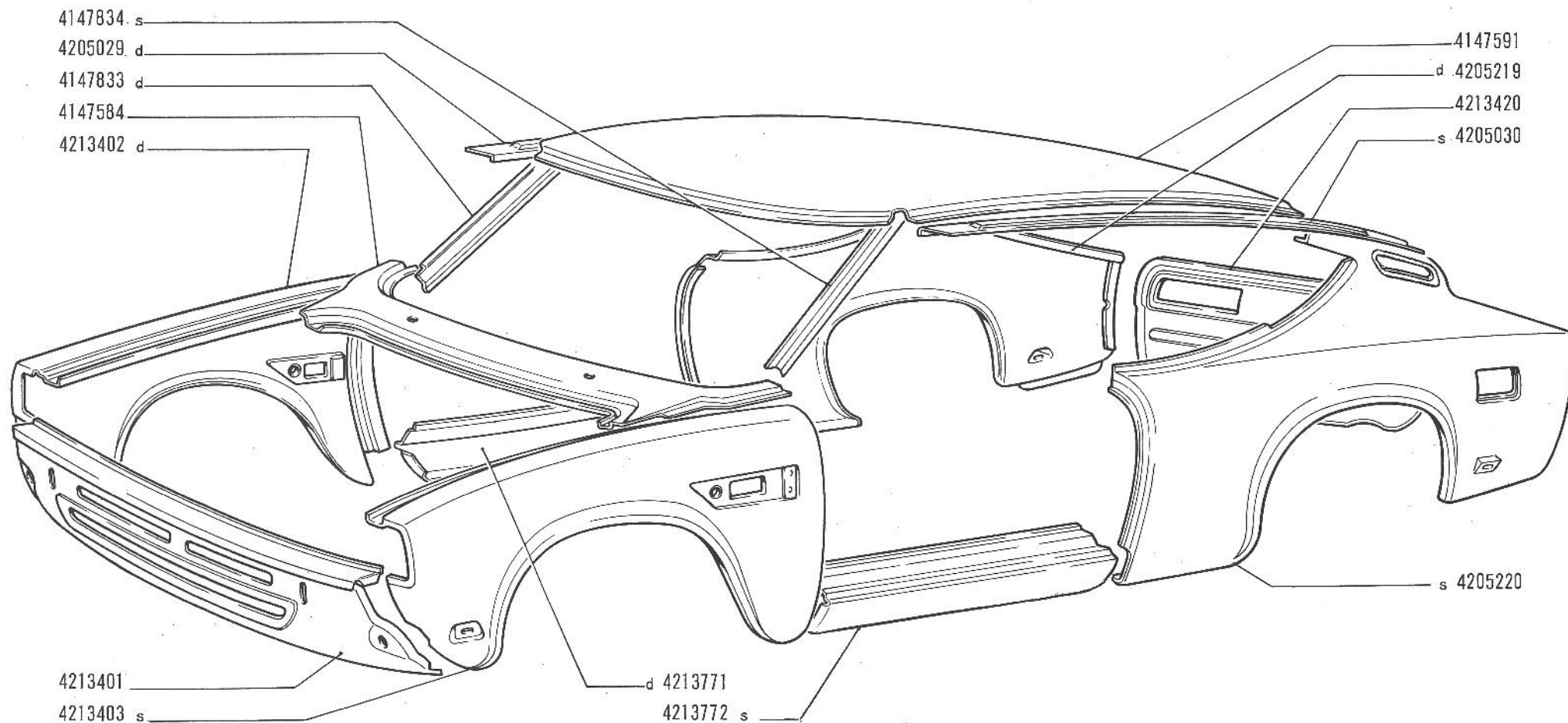

(16311)

FIAT DINO 2400
(tipo 135 BC)

SCocca, ELEMENTI ESTERNI

- Coque, éléments extérieurs
- Wagenkasten-Aussenteile

- Body Shell Outer Elements
- Caja, elementos exteriores

L1.05

X-1969

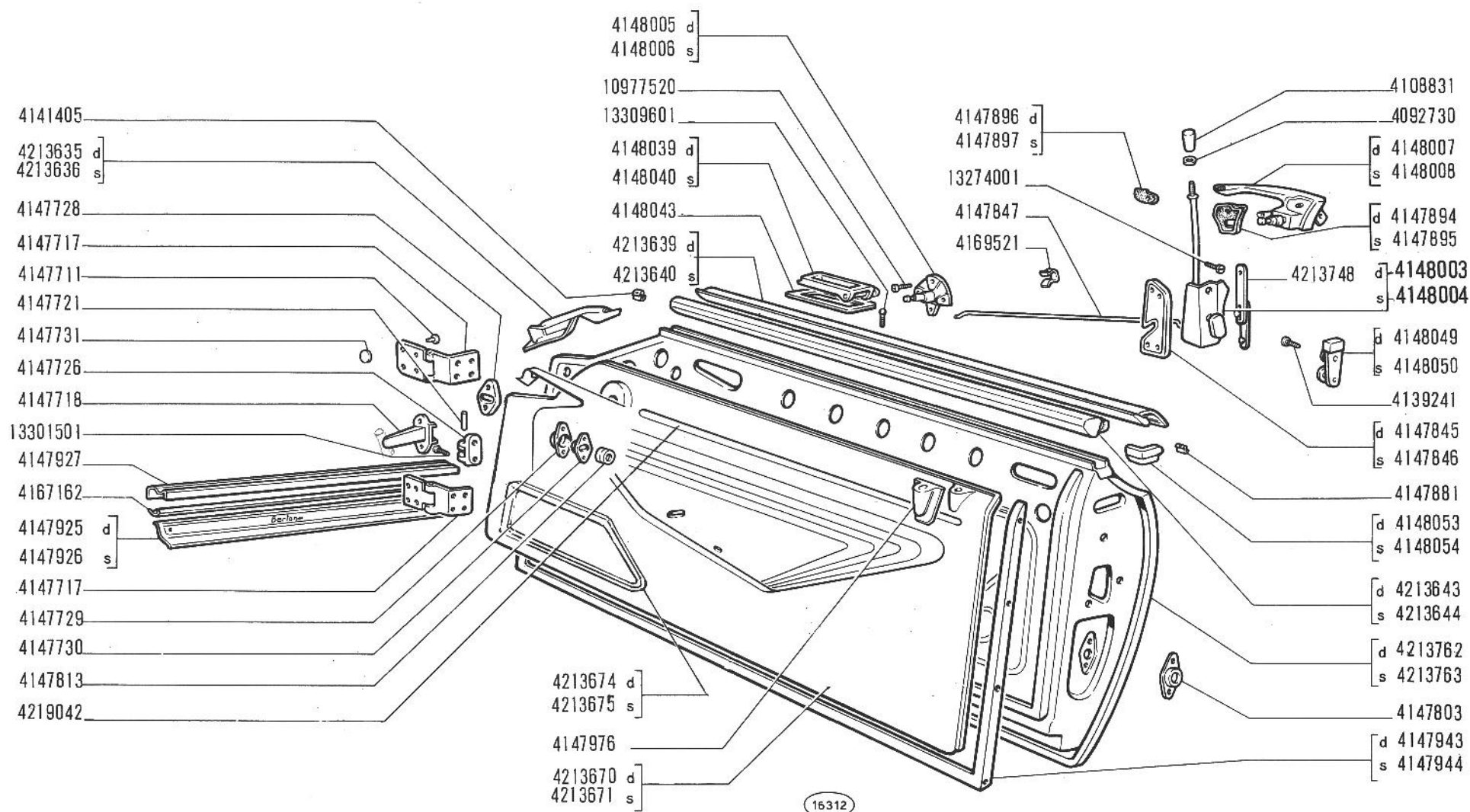

FIAT DINO 2400
(tipo 135 BC)

• Portes
• Türen

PORTE

• Doors
• Puertas

L1.09

1/3

X-1969

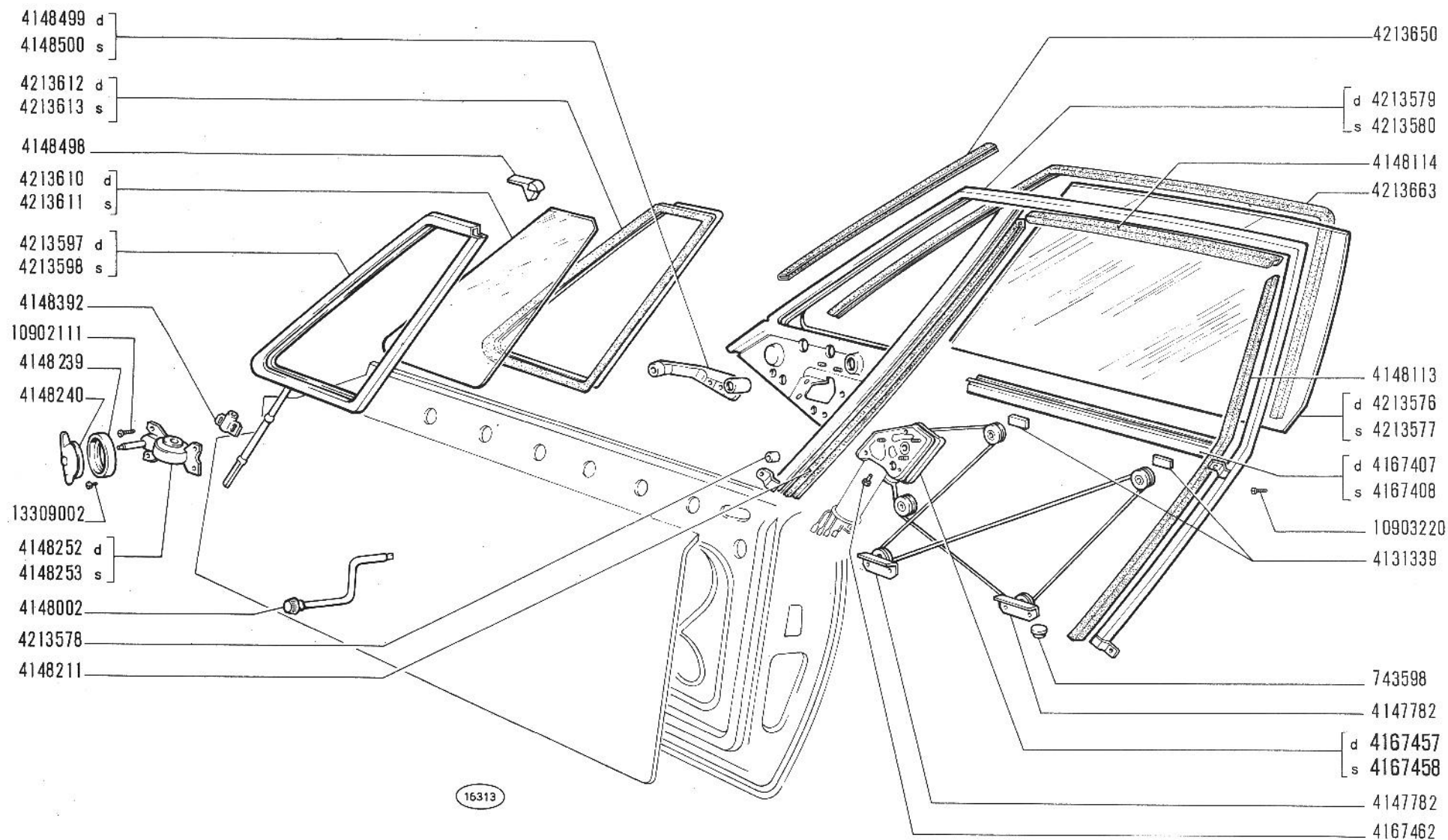

FIAT DINO 2400
(tipo 135 BC)

● Portes
● Türen

PORTE

● Doors
● Puertas

L1.09

2/3

X-1969

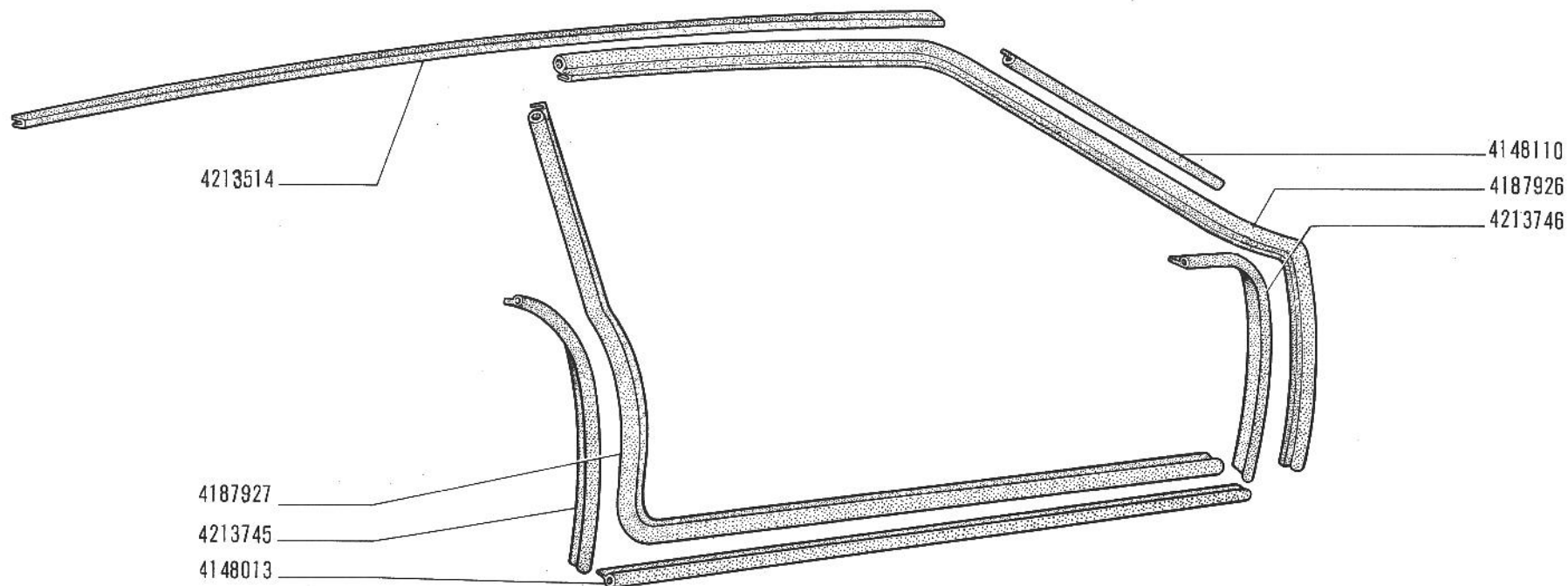

FIAT DINO 2400
(tipo 135 BC)

● Portes
● Türen

PORTE

● Doors
● Puertas

L1.09

3/3

X-1969

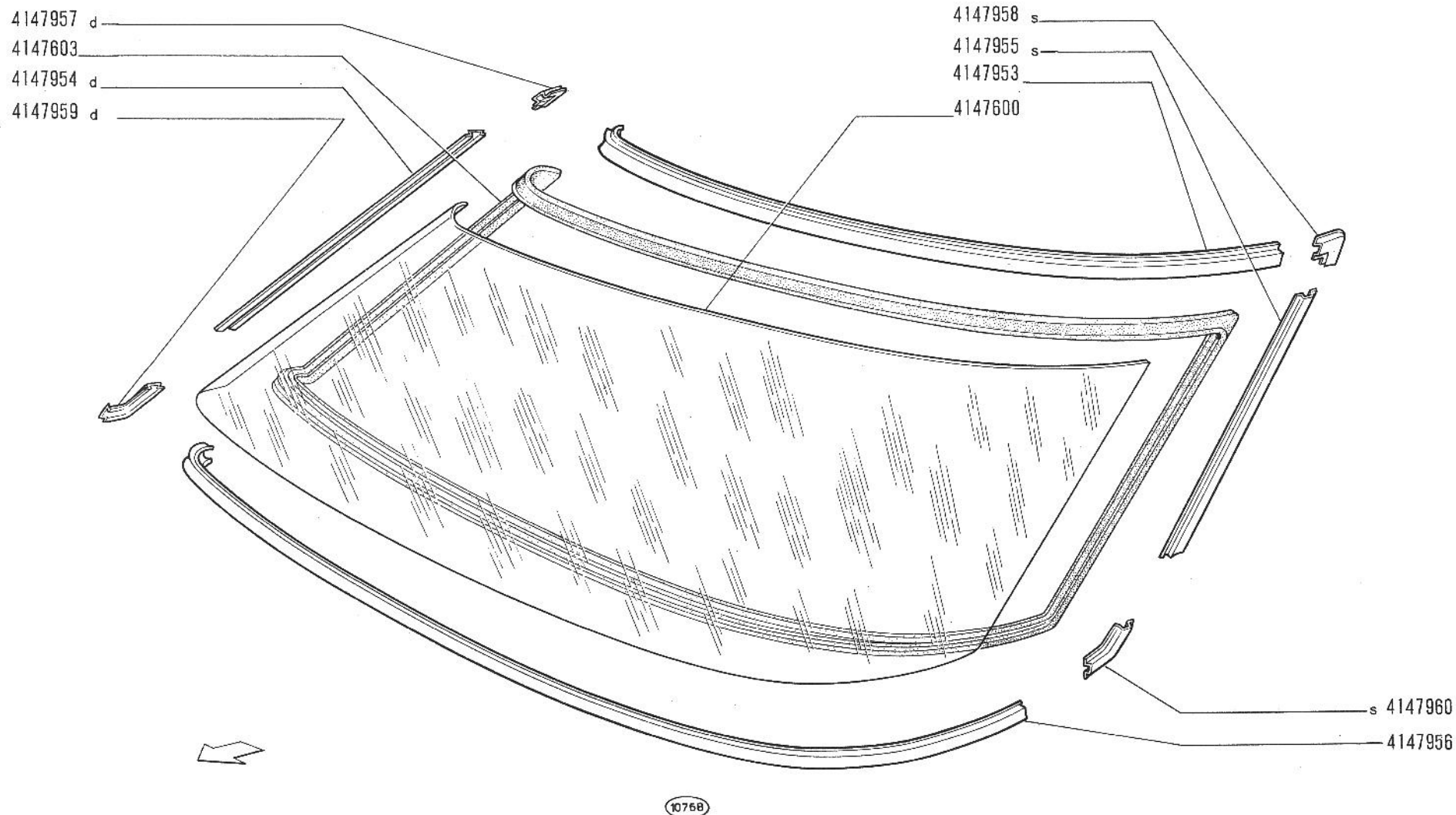

FIAT DINO 2400
(tipo 135 BC)

- Pare-brise
- Windschutzscheibe

PARABREZZA

- Windshield
- Parabrisas

L1.18

X-1969

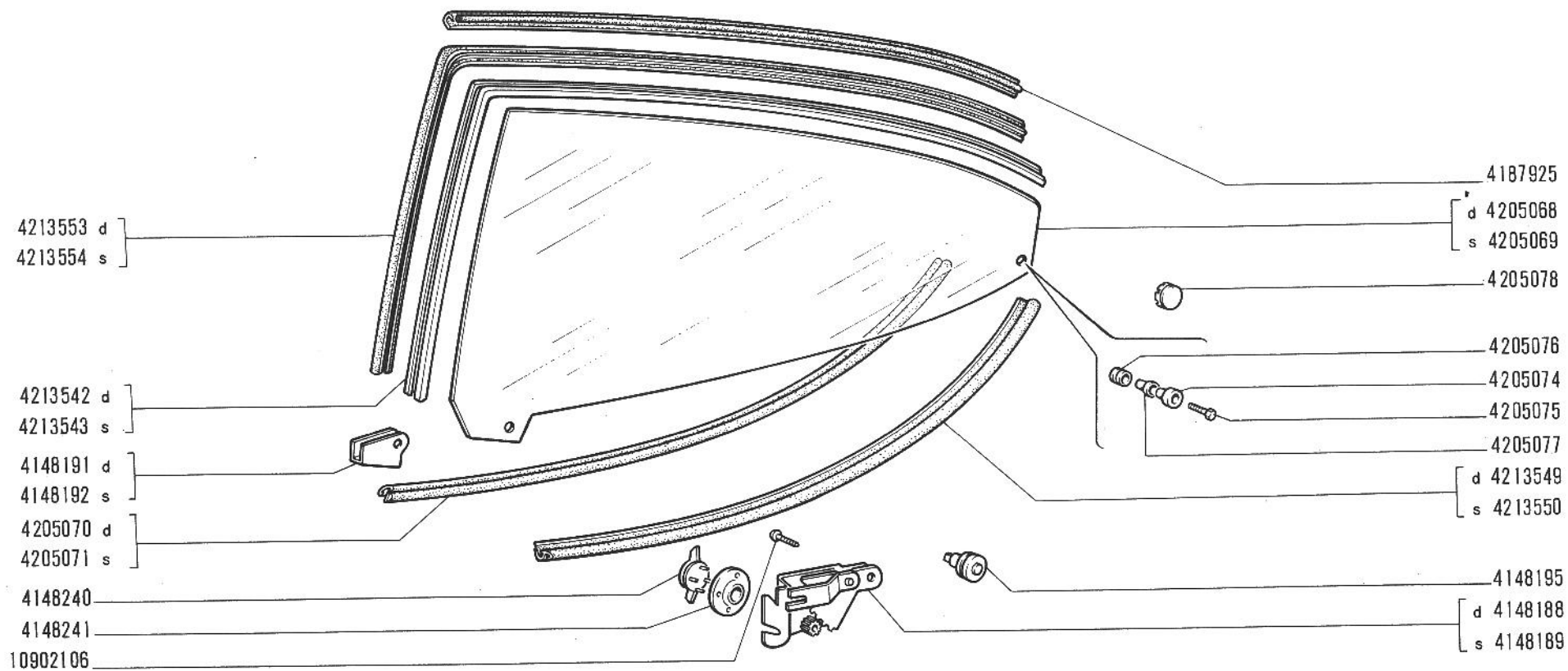

FIAT DINO 2400
(tipo 135 BC)

- Baie de custode
- Seitenfenster

FINESTRA LATERALE

- Rear Quarter Window
- Ventana lateral

L1.19

X-1969

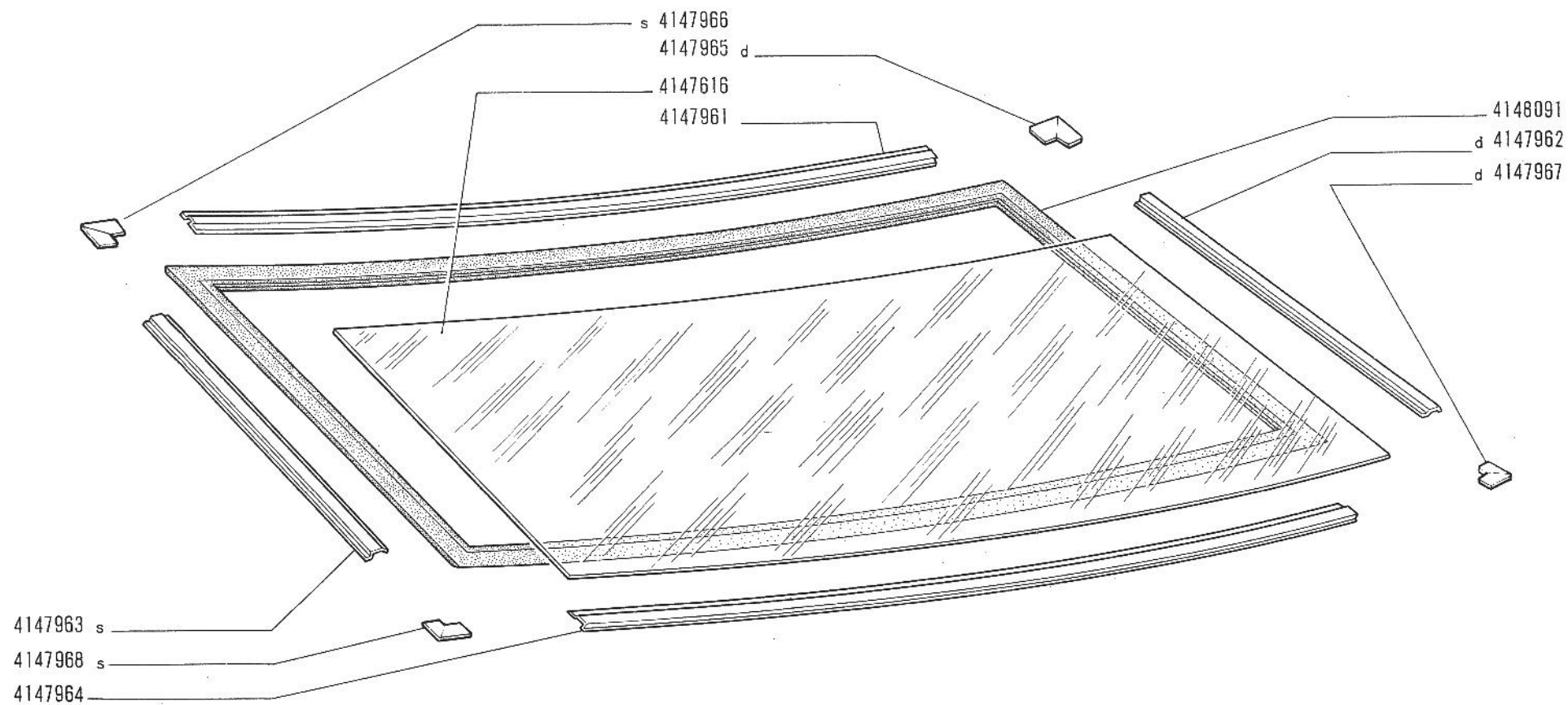

10770

FIAT DINO 2400
(tipo 135 BC)

- Lunette AR
- Rückwandfenster

FINESTRA POSTERIORE

- Back Window
- Ventana trasera

L1.20

X-1969

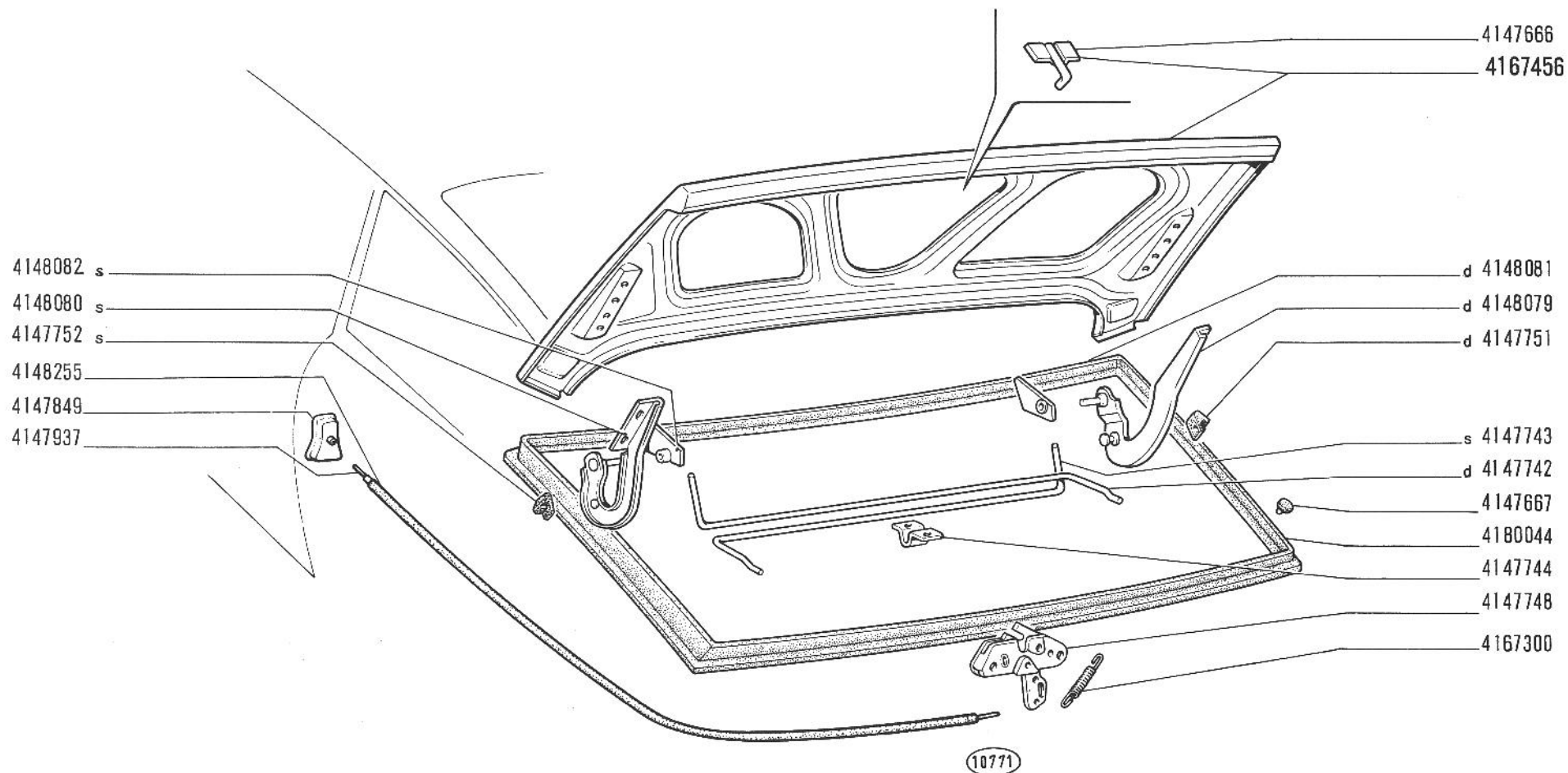

FIAT DINO 2400
(tipo 135 BC)

COPERCHIO VANO BAGAGLI

- Couvercle de coffre
- Kofferraumdeckel

- Luggage Compartment Lid
- Tapa del baúl

L1.23

X-1969

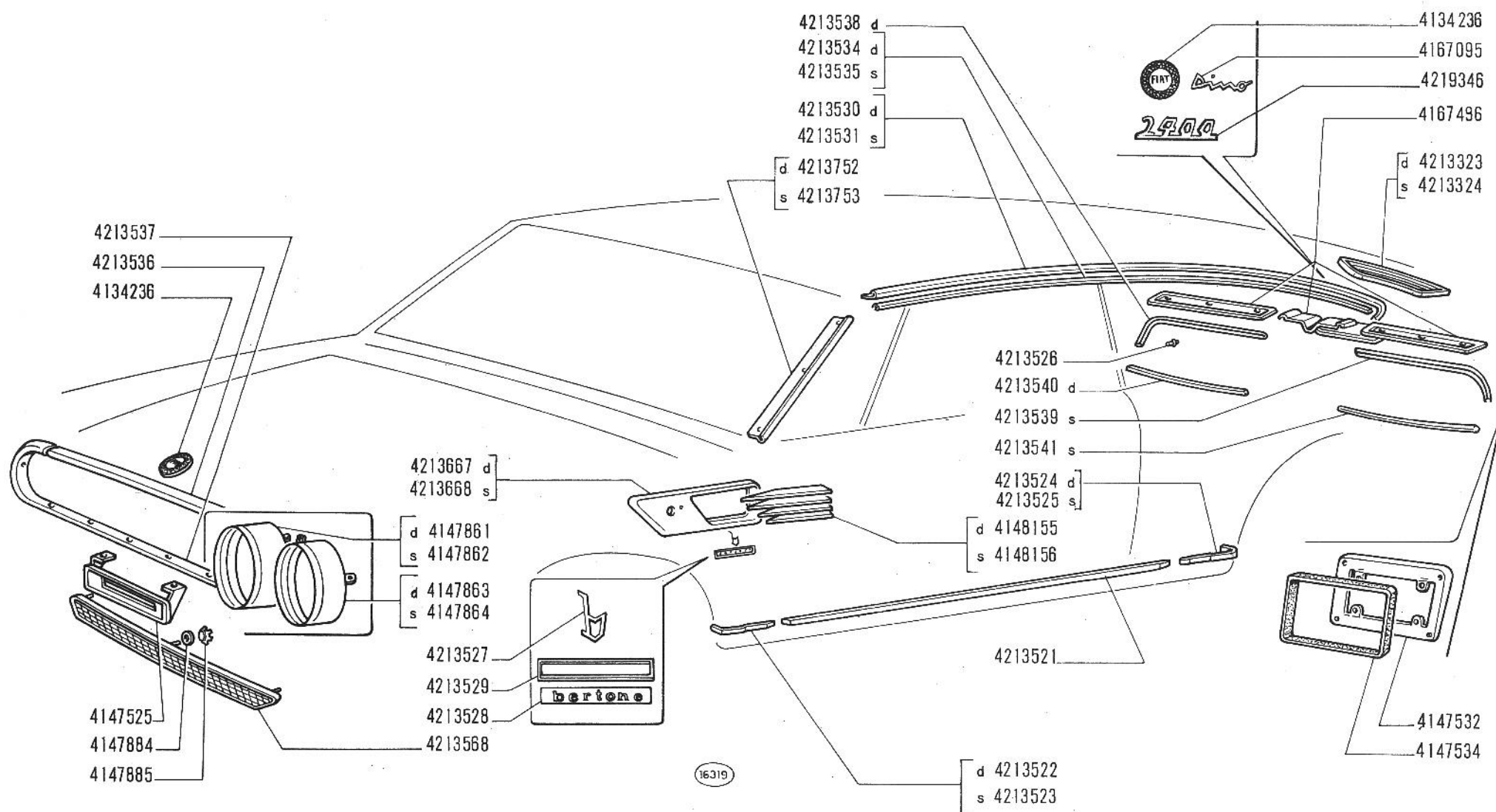

FIAT DINO 2400
(tipo 135 BC)

MODANATURE E GUARNIZIONI ESTERNE

- Moulures et garnitures extérieures
- Äussere Verzierungen

- Outer Trim Mouldings
- Molduras exteriores

L1.25

X-1969

modif.	n. ordinaz.	quant.	Denominazione	Désignation	Benennung	Description	Denominaciones
	4213667	1	Cornice sfiato aria ant.d	Monture	Rahmen	Frame	Marco
	4213668	1	Cornice sfiato aria ant.s	Monture	Rahmen	Frame	Marco
	4213752	1	Gocciolatoio montante ant.d	Gouttière	Dachrinne	Trough	Vierteaguas
	4213753	1	Gocciolatoio montante ant.s	Gouttière	Dachrinne	Trough	Vierteaguas
	4219346	1	Sigla post	Motif	Firmen kennzeichen	Make medallion	Emblema
L1.25			FIAT Dino Coupe BC				

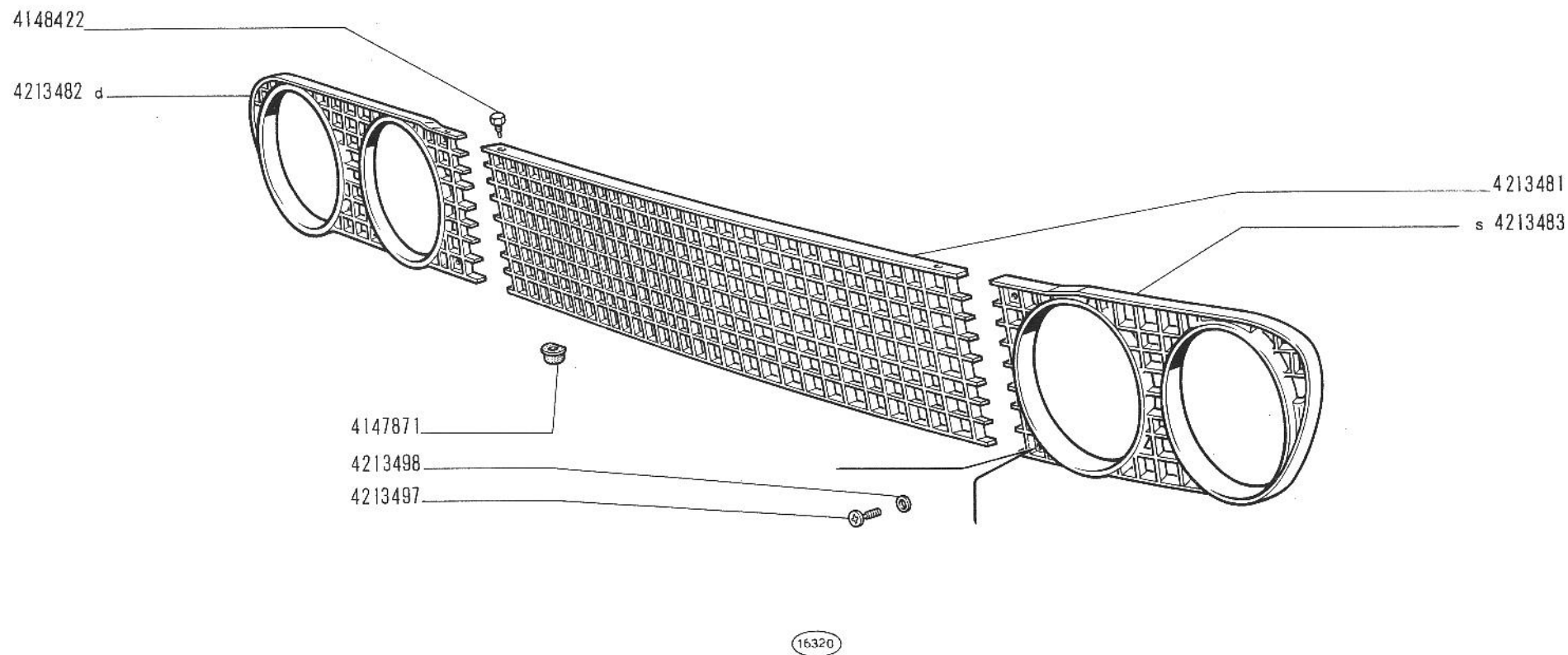

FIAT DINO 2400
(tipo 135 BC)

- Grille de radiateur
- Kühlergitter

GRIGLIA RADIATORE

- Radiator grille
- Calandra de radiador

L3.01

X-1969

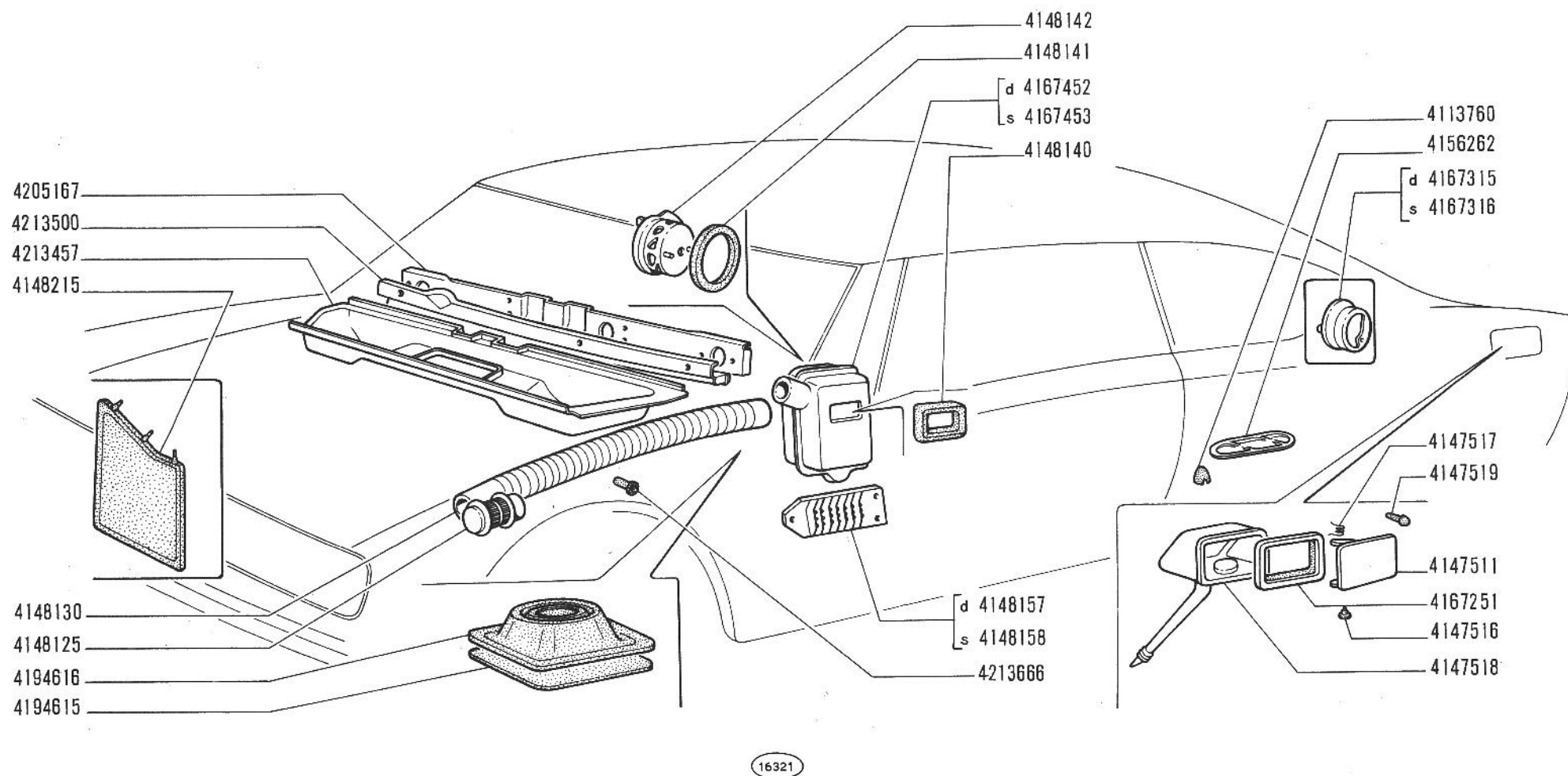

FIAT DINO 2400
(tipo 135 BC)

- *Protections*
- *Abdeckungen und Dichtungen*

RIPARI

- *Protection Items*
- *Elementos de protección*

L3.02

X-1969

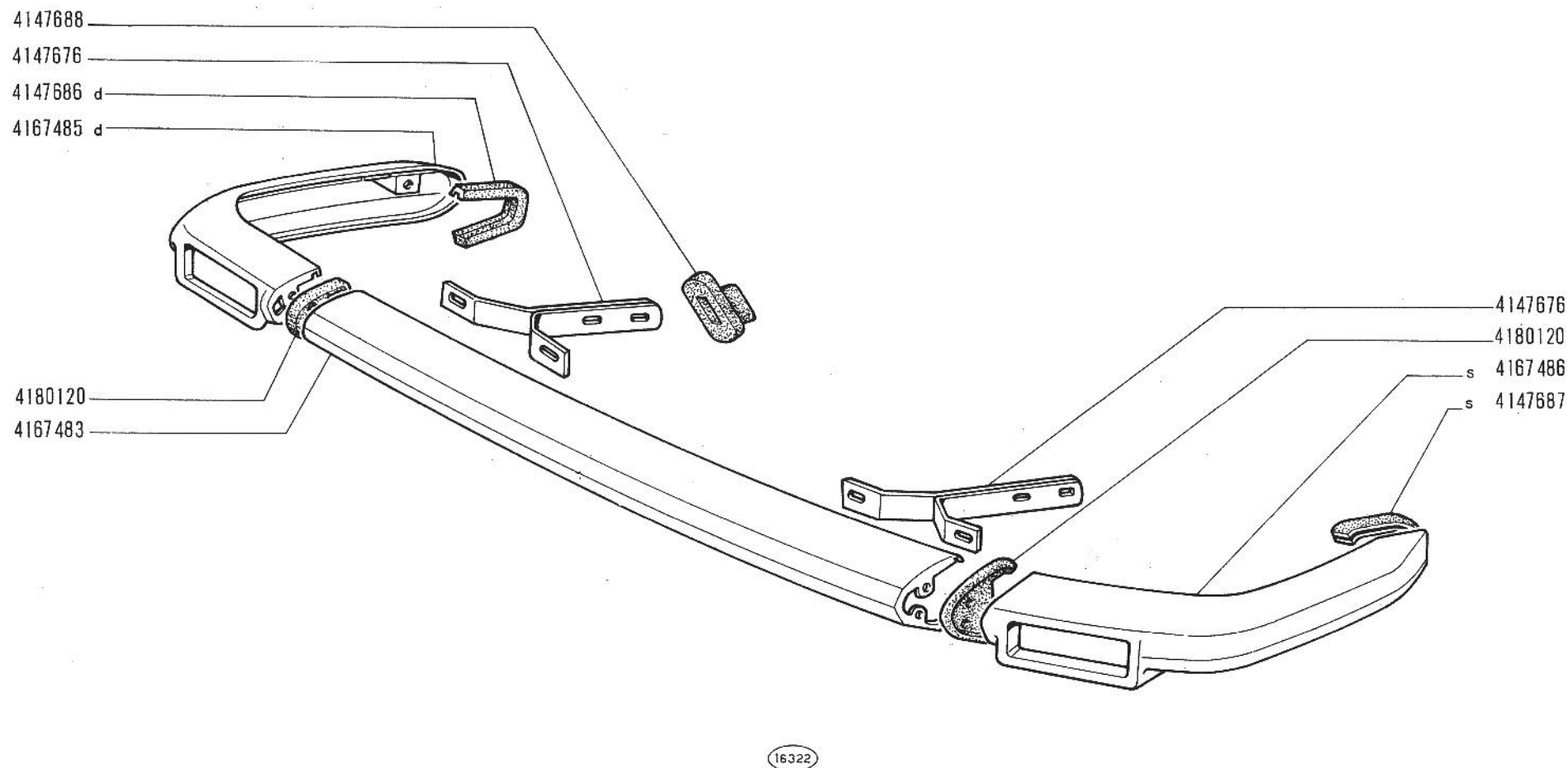

FIAT DINO 2400
(tipo 135 BC)

- Pare-chocs AV
- Vorderer Stossfänger

PARAURTI ANTERIORE

- Front Bumper
- Parachoques anterior

L3.06

X-1969

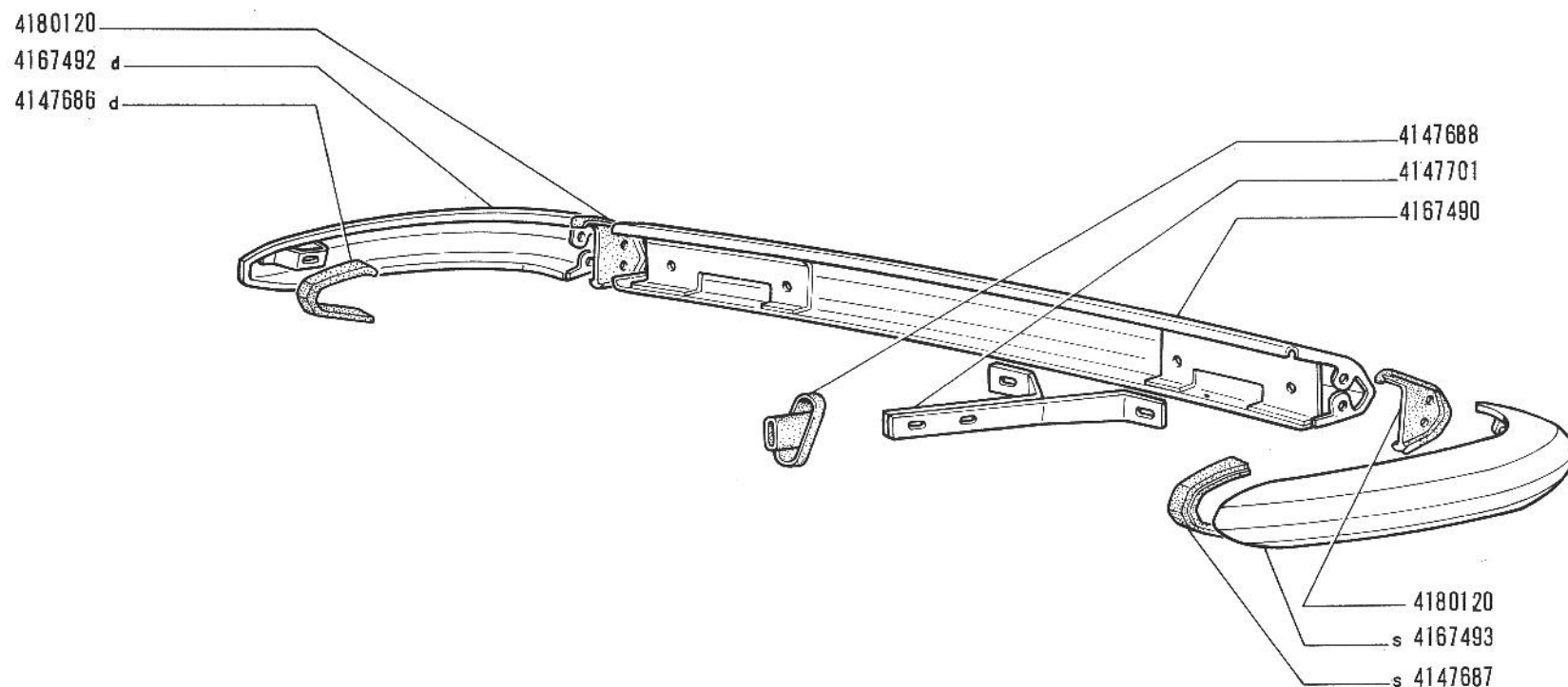

FIAT DINO 2400
(tipo 135 BC)

- Pare-chocs AR
- Hinterer Stossfänger

PARAURTI POSTERIORE

- Rear Bumper
- Parachoques posterior

L3.07

X-1969

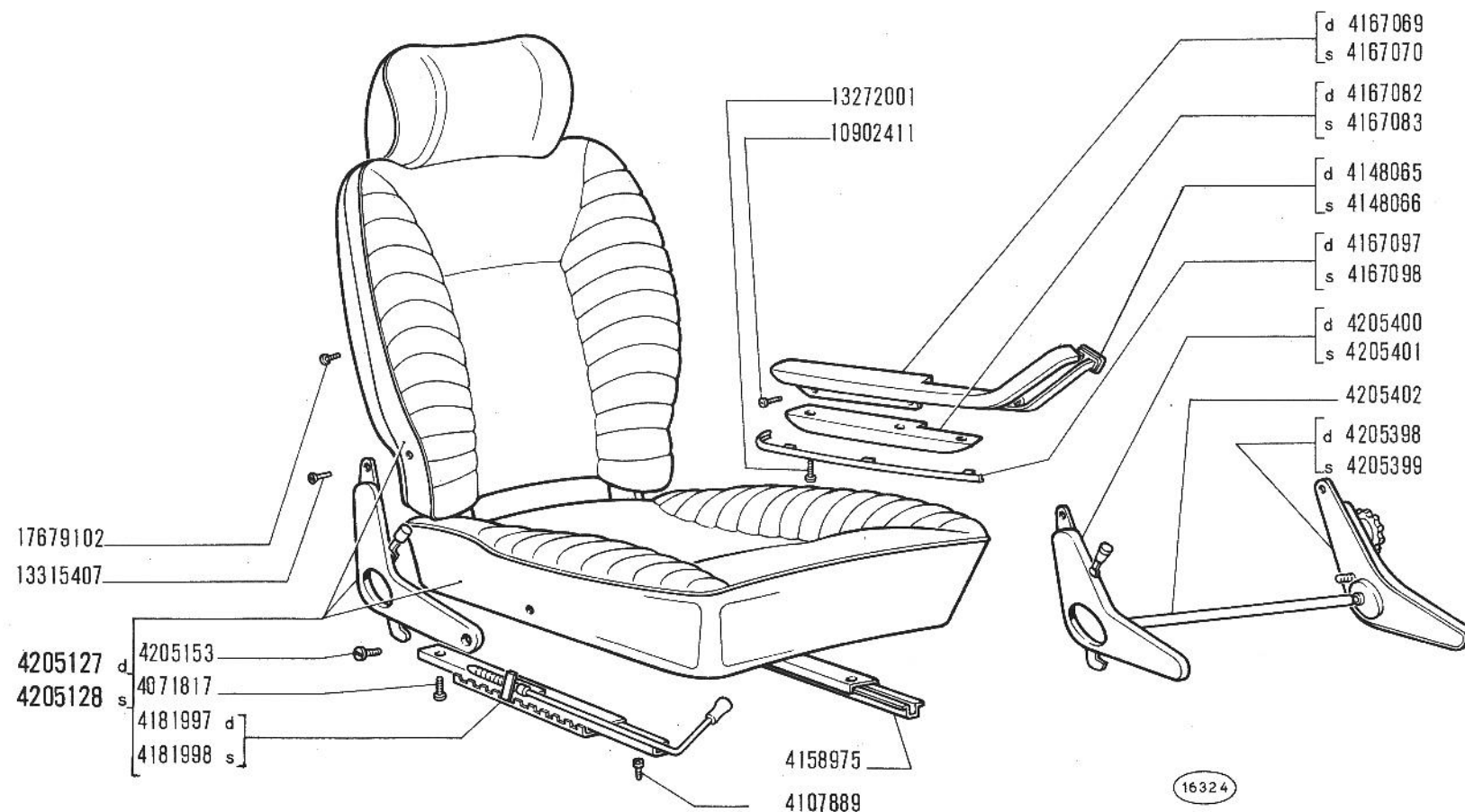

FIAT DINO 2400
(tipo 135 BC)

• Sièges avant
• Vordersitze

SEDILI ANTERIORI

• Front Seats
• Butacas anteriores

M1.01

X-1969

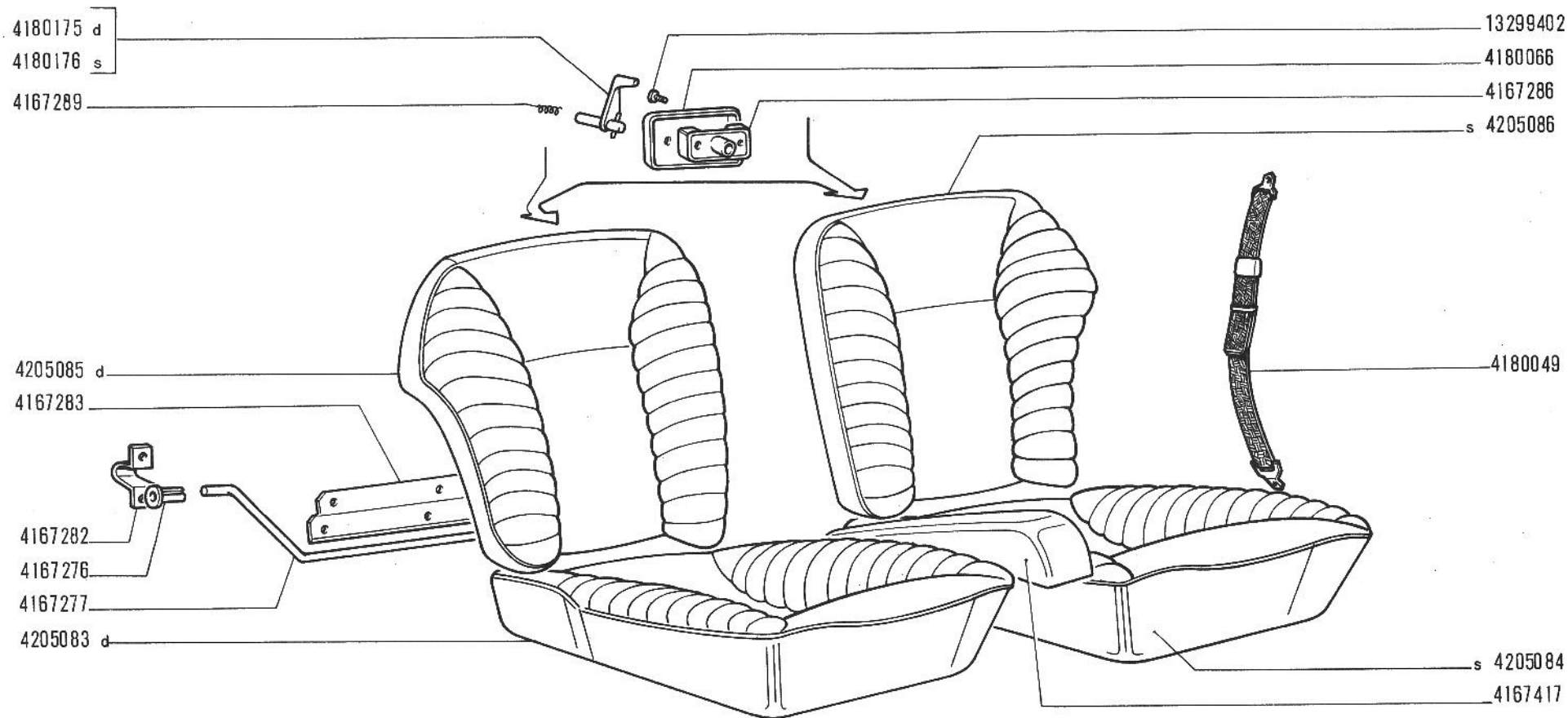

FIAT DINO 2400
(tipo 135 BC)

• *Siège arrière*
• *Hintersitz*

SEDILE POSTERIORE

• *Rear Seat*
• *Butaca posterior*

M1.02

X-1969

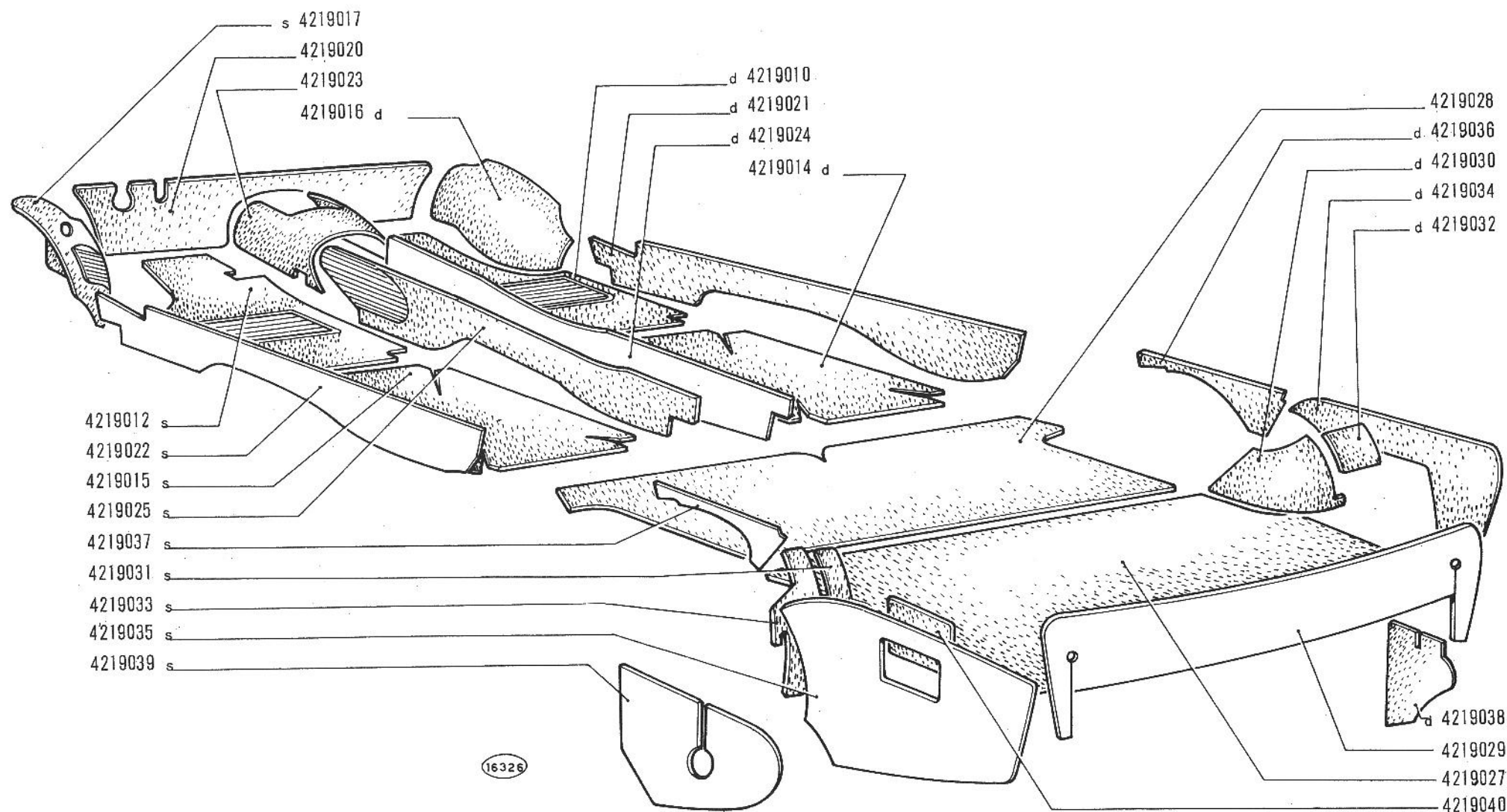

FIAT DINO 2400
(tipo 135 BC)

- Tapis
- Bodenbeläge

TAPPETI

- Mats
- Alfombras

M1.06

X-1969

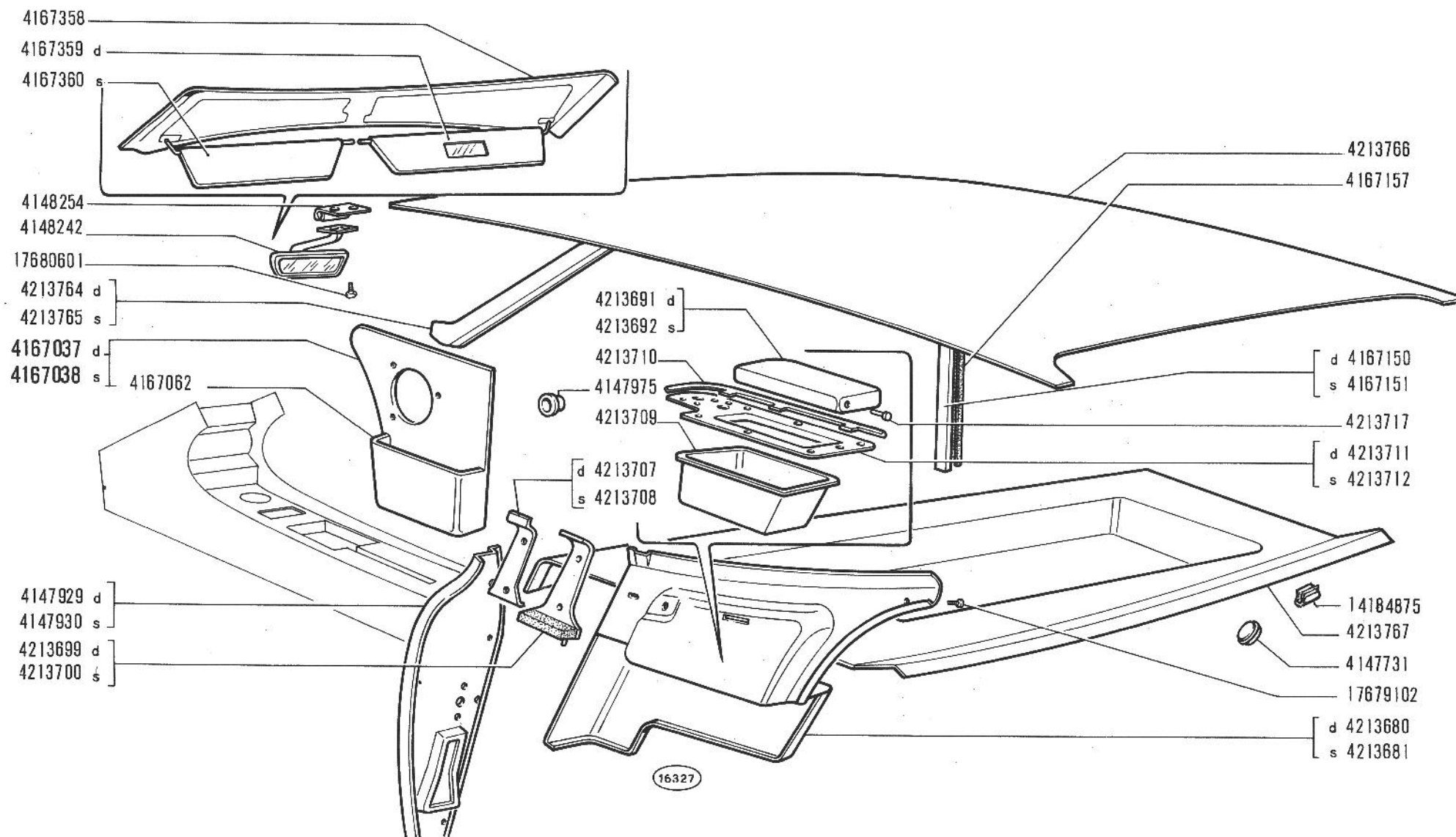

FIAT DINO 2400
(tipo 135 BC)

ACCESSORI E RIVESTIMENTI INTERNI

- Accessoires et garnissages intérieurs
- Inneres Zubehör und Verkleidungen

- Interior Trim and Accessories
- Accesorios y tapizado interiores

M1.07

1/2

X-1969

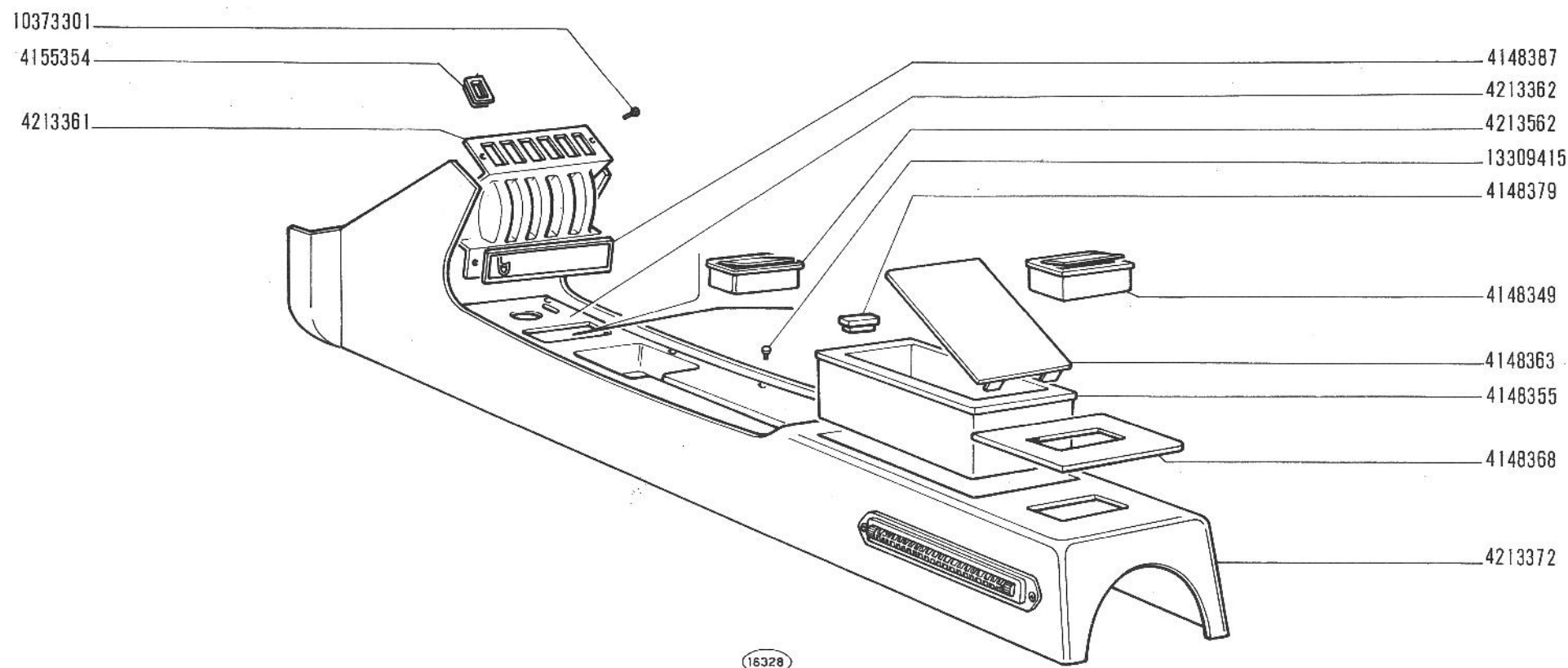

FIAT DINO 2400
(tipo 135 BC)

ACCESSORI E RIVESTIMENTI INTERNI

- Accessoires et garnissages intérieurs
- Inneres Zubehör und Verkleidungen

- Interior Trim and Accessories
- Accesorios y tapizado interiores

M1.07

2 2

X-1969

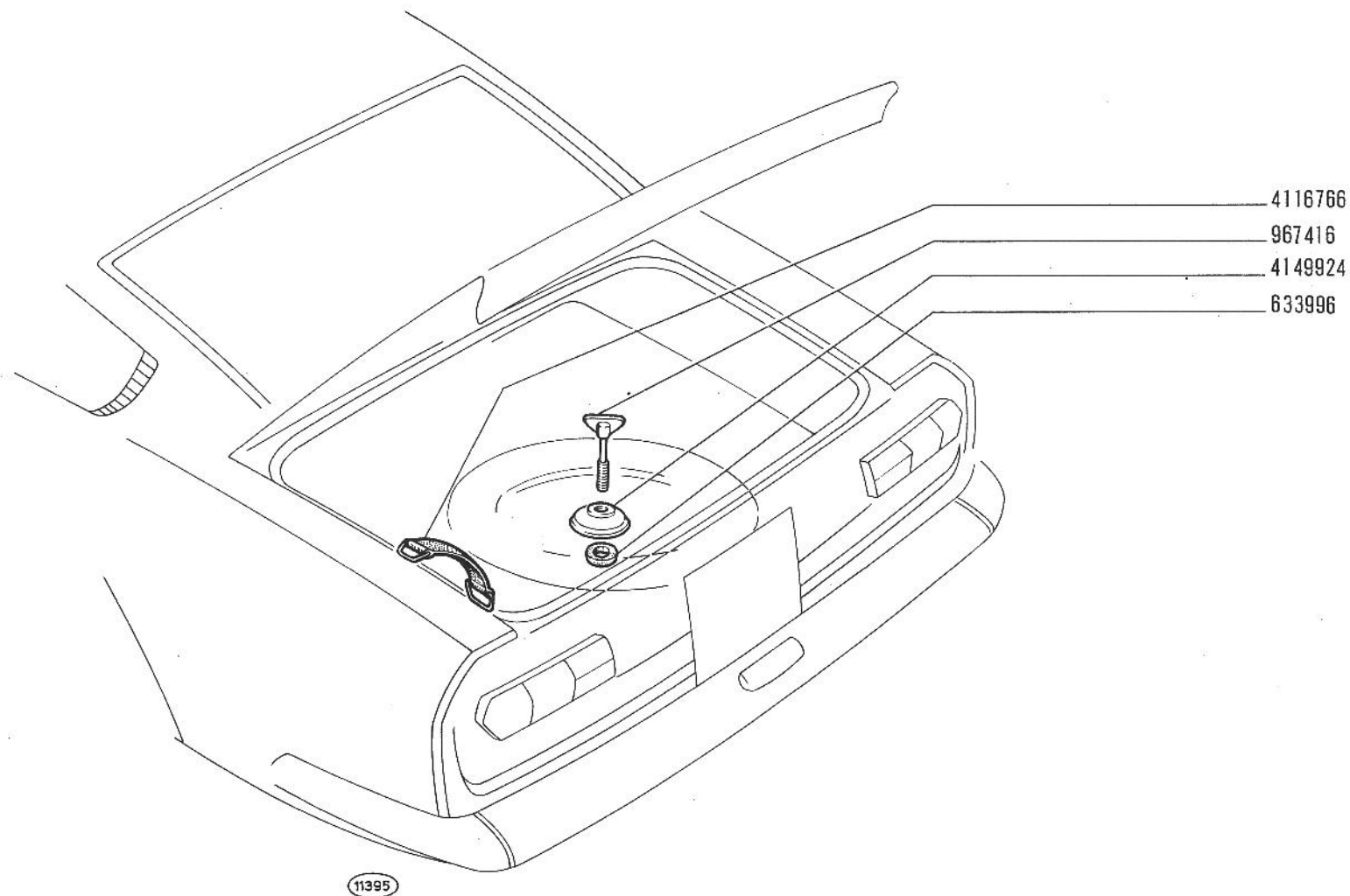

FIAT DINO 2400
(tipo 135 BC)

SISTEMAZIONE RUOTA DI SCORTA

- *Aménagement roue de secours*
- *Unterbringung des Ersatzrads*

- *Spare Wheel Arrangement*
- *Cavidad para rueda de repuesto*

M1.08

X-1969